

Darbeli Soketler ve Aksesuarlar



PROFESSIONAL TOOLS

Metric Impact Sockets

Item No.	A mm	D1 mm	D2 mm	Length mm	Weight g	PCS inner/ctn	G.W. KGS	CUFT
2503	3	6.1	12	25	9	20 / 300	4.0	0.69
2504	4	7.3	12	25	9	20 / 300	4.0	0.69
2545	4.5	7.9	12	25	10	20 / 300	4.0	0.69
2505	5	8.5	12	25	10	20 / 300	4.0	0.69
2555	5.5	9.1	12	25	10	20 / 300	4.0	0.69
2506	6	9.7	12	25	11	20 / 300	4.5	0.69
2507	7	11.0	12	25	11	20 / 300	4.5	0.69
2508	8	12.0	12	25	11	20 / 300	4.5	0.69
2509	9	13.0	13	25	13	20 / 300	5.5	0.69
2510	10	14.0	14	25	15	20 / 300	6.0	0.69
2511	11	16.0	16	25	20	20 / 300	8.0	0.69
2512	12	17.0	17	25	25	20 / 300	9.0	0.69
2513	13	18.0	18	25	30	20 / 300	10.0	0.69
2514	14	20.0	20	25	35	20 / 300	11.5	0.69



6 pt.

SAE Impact Sockets

Item No.	A inch	D1 mm	D2 mm	Length mm	Weight g	PCS inner/ctn	G.W. KGS	CUFT
2904	1/8	6.2	12	25	9	20 / 300	4.0	0.69
2906	3/16	8.2	12	25	10	20 / 300	4.0	0.69
2907	7/32	9.2	12	25	10	20 / 300	4.0	0.69
2908	1/4	10.2	12	25	11	20 / 300	4.0	0.69
2909	9/32	11.2	12	25	12	20 / 300	4.5	0.69
2910	5/16	12.0	12	25	12	20 / 300	4.5	0.69
2911	11/32	13.0	13	25	14	20 / 300	5.5	0.69
2912	3/8	14.0	14	25	16	20 / 300	6.0	0.69
2914	7/16	16.0	16	25	20	20 / 300	7.5	0.69
2916	1/2	18.0	18	25	30	20 / 300	9.5	0.69
2918	9/16	20.0	20	25	35	20 / 300	11.5	0.69

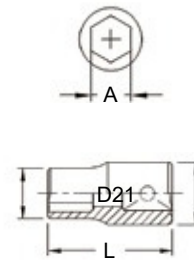

AF-214M 14 Piece 1/4" Dr. Metric Impact Socket Set

Item No. Size Item No. Size
1/4" Dr. 6pt Impact Socket:

3mm	8mm
4mm	9mm
4.5mm	10mm
5mm	11mm
5.5mm	12mm
6mm	13mm
7mm	14mm



6 pt.

310 g 10x6 60 sets / 19.5 Kgs / 1.58 CUFT

AF-211S 11 Piece 1/4" Dr. SAE Impact Socket Set

Item No. Size Item No. Size
1/4" Dr. 6pt Impact Socket:

1/8"	
3/16"	11/32"
7/32"	3/8"
1/4"	7/16"
9/32"	1/2"
5/16"	9/16"



6 pt.

260 g 10x6 60 sets / 18 Kgs / 1.58 CUFT



Impact Sockets

Metric Deep Impact Sockets

Item No.	A mm	D1 mm	D2 mm	Length mm	Weight g	PCS inner/ctn	G.W. KGS	CUFT
215204	4	7.3	12.0	50	16	10 / 200	4.5	0.39
215245	4.5	7.9	12.0	50	17	10 / 200	4.5	0.39
215205	5	8.5	12.0	50	18	10 / 200	4.5	0.39
215255	5.5	9.1	12.0	50	19	10 / 200	4.5	0.39
215206	6	9.7	12.0	50	20	10 / 200	5.0	0.39
215207	7	11.0	12.0	50	20	10 / 200	5.5	0.39
215208	8	12.0	11.2	50	20	10 / 200	5.5	0.39
215209	9	13.0	12.0	50	25	10 / 200	6.5	0.39
215210	10	14.5	12.5	50	30	10 / 200	7.5	0.39
215211	11	16.0	13.0	50	35	10 / 200	8.0	0.39
215212	12	17.0	13.5	50	35	10 / 200	8.0	0.39
215213	13	19.0	14.0	50	50	10 / 200	10.0	0.60
215214	14	20.0	14.5	50	50	10 / 200	11.0	0.60



SAE Deep Impact Sockets

Item No.	A inch	D1 mm	D2 mm	Length mm	Weight g	PCS inner/ctn	G.W. KGS	CUFT
295206	3/16	8.2	12.0	50	17	10 / 200	4.5	0.39
295207	7/32	9.2	12.0	50	18	10 / 200	4.5	0.39
295208	1/4	10.2	12.0	50	20	10 / 200	5.0	0.39
295209	9/32	11.2	12.0	50	20	10 / 200	5.5	0.39
295210	5/16	12.0	11.2	50	20	10 / 200	5.5	0.39
295211	11/32	13.0	12.0	50	25	10 / 200	6.5	0.39
295212	3/8	14.0	12.5	50	30	10 / 200	8.0	0.39
295214	7/16	16.0	13.0	50	30	10 / 200	8.0	0.39
295216	1/2	18.0	14.0	50	45	10 / 200	10.0	0.60
295218	9/16	20.0	15.0	50	50	10 / 200	11.0	0.60

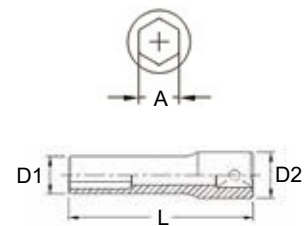

Impact Adapter

Item No.	Female Drive	Male Drive	Length mm	Weight g	PCS inner/ctn	G.W. KGS	CUFT
29030	1/4"	3/8"	25	15	20 / 600	10.0	0.38



Impact Bit Holders

Item No.	Hex Shank	Length mm	Weight g	PCS inner/ctn	G.W. KGS	CUFT
26308	1/4"	35	20	10 / 300	7.0	0.38
26310	5/16"	35	25	10 / 300	8.0	0.38



Impact Bit Holder

Item No.	Hex Shank	Length mm	Weight g	PCS inner/ctn	G.W. KGS	CUFT
262808	1/4"	25	16	20 / 600	11.0	0.38



Impact Extension Bars

Item No.	Length mm (inch)	Weight g	PCS inner/ctn	G.W. KGS	CUFT
21002	50 (2")	25	25 / 400		0.30
21003	75 (3")	35	25 / 400	11.0	0.30
21004	100 (4")	45	20 / 240	15.0	0.30
21006	150 (6")	65	20 / 240	12.0	0.30
21009	225 (9")	95	20 / 200	17.0	0.41
21012	300 (12")	125	15 / 180	20.5	0.52
				23.5	



Impact Universal Joint

Item No.	Outside Diameter	Length mm	Weight g	PCS inner/ctn	G.W. KGS	CUFT
70016	14mm	35	20	10 / 300	7.0	0.38



Impact Socket Sets

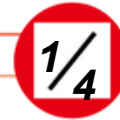

AD-211M 11 Piece 1/4" Dr. Metric Deep Impact Socket Set

Item No.	Size	ItemNo.	Size
----------	------	---------	------

1/4" Dr. 6pt Deep Impact Socket:

4mm	9mm
5mm	10mm
5.5mm	11mm
6mm	12mm
7mm	13mm
8mm	

400 g

5x4 20 sets / 9 Kgs / 0.71 CUFT



6 pt.

AD-210S 10 Piece 1/4" Dr. SAE Deep Impact Socket Set

Item No.	Size	ItemNo.	Size
----------	------	---------	------

1/4" Dr. 6pt Deep Impact Socket:

3/16"	11/32"
7/32"	3/8"
1/4"	7/16"
9/32"	1/2"
5/16"	9/16"

350 g

5x4 20 sets / 8 Kgs / 0.71 CUFT



6 pt.

AF-255MS 55 Piece 1/4" Dr. Metric & SAE Deep Impact Socket Set

Item No.	Size	Item No.	Size
----------	------	----------	------

1/4" Dr. 6pt Impact Socket:

3mm	
4mm	
4.5mm	1/8"
5mm	3/16"
5.5mm	7/32"
6mm	1/4"
7mm	9/32"
8mm	5/16"
9mm	11/32"
10mm	3/8"
11mm	7/16"
12mm	1/2"
13mm	9/16"
14mm	

Item No. Size

1/4" Dr. Accessory:

Impact Extension Bar, 50mmL
 Impact Extension Bar, 75mmL
 Impact Extension Bar, 100mmL
 Impact Extension Bar, 150mmL
 Impact Bit Holder
 Adapter, 1/4"F x 3/8"M
 Impact Universal Joint



1/4" Dr. 6pt Deep Impact Socket:

6 pt.



Metric Impact Sockets

Item No.	A mm	D1 mm	D2 mm	Length mm	Weight g	PCS inner/ctn	KGS	CUFT
31306	6	11.0	18.8	28	35	20 / 300	13.0	0.69
31307	7	12.0	18.8	28	35	20 / 300	13.0	0.69
31308	8	13.5	18.8	28	35	20 / 300	13.0	0.69
31309	9	15.0	18.8	28	35	20 / 300	13.0	0.69
31310	10	16.0	18.8	28	35	20 / 300	13.0	0.69
31311	11	17.0	18.8	30	40	20 / 300	13.0	0.69
31312	12	18.8	18.8	30	40	20 / 300	13.0	0.69
31313	13	19.8	19.8	30	40	20 / 300	13.5	0.69
31314	14	22.0	22.0	30	55	20 / 300	19.0	0.69
31315	15	22.0	22.0	30	55	20 / 300	19.0	0.69
31316	16	23.8	23.8	30	60	20 / 300	20.0	0.69
31317	17	24.8	24.8	32	70	20 / 300	23.0	0.69
31318	18	25.8	25.8	32	75	20 / 300	24.5	0.69
31319	19	27.8	27.8	32	85	20 / 300	28.0	0.69
31320	20	27.8	27.8	32	85	20 / 300	28.0	0.69
31321	21	29.8	29.8	32	100	20 / 300	34.0	0.69
31322	22	31.8	31.8	32	110	20 / 300	36.0	0.69

6 pt.



16 Piece 3/8" Dr. Metric Impact Socket Set

D2

Item No.	Size	Item No.	Size
3/8" Dr. 6pt Impact Socket:			
7mm	15mm		
8mm	16mm		
9mm	17mm		
10mm	18mm		
11mm	19mm		
12mm	20mm		
13mm	21mm		
14mm	22mm		

6 pt.



1200 g 20x1 20 sets / 25 Kgs / 0.88 CUFT

AF-313S 13 Piece 3/8" Dr. SAE Impact Socket Set

Item No.	Size	Item No.	Size
3/8" Dr. 6pt Impact Socket:			
393010	5/16"	393020	5/8"
393011	11/32"	393022	11/16"
393012	3/8"	393024	3/4"
393014	7/16"	393025	25/32"
393016	1/2"	393026	13/16"
393018	9/16"	393028	7/8"
393019	19/32"		Socket Holder

6 pt.



1000 g 15x1 15 sets / 16 Kgs / 0.73 CUFT

Metric Deep Impact Sockets

Item No.	A mm	D1 mm	D2 mm	Length mm	Weight g	PCS inner/ctn	G.W	CUFT
31636	6	11.0	18.8	63	90	10 / 200		0.60
31637	7	12.0	18.8	63	90	10 / 200	20.0	0.60
31638	8	13.5	18.8	63	90	10 / 200	20.0	0.60
31639	9	15.0	18.8	63	90	10 / 200	20.0	0.60
31610	10	16.0	18.8	63	90	10 / 200	20.0	0.60
31611	11	17.0	18.8	63	90	10 / 200	20.0	0.60
31612	12	19.0	18.8	63	90	10 / 200	20.0	0.60
31613	13	19.8	19.8	63	90	10 / 200	20.0	0.60
31614	14	22.0	22.0	63	110	10 / 200	20.0	0.60
31615	15	22.0	22.0	63	120	10 / 200	25.0	0.60
31616	16	23.8	23.8	63	130	10 / 200	25.0	0.60
31617	17	24.8	24.8	63	140	10 / 120	27.0	0.35
31618	18	25.8	25.8	63	140	10 / 120	18.0	0.35
31619	19	27.8	27.8	63	160	10 / 120	19.0	0.35
31620	20	27.8	27.8	63	170	10 / 120	21.0	0.52
31621	21	29.8	29.8	63	210	10 / 120	21.5	0.52
31622	22	31.8	31.8	63	240	10 / 60	27.5	0.45
							16.0	

6 pt.



SAE Deep Impact Sockets

Item No.	A inch	D1 mm	D2 mm	Length mm	Weight g	PCS inner/ctn	KGS	CUFT
39608	1/4	11.0	18.8	63	90	10 / 200	20.0	0.60
39610	5/16	13.5	18.8	63	90	10 / 200	20.0	0.60
39611	11/32	14.5	18.8	63	90	10 / 200	20.0	0.60
39612	3/8	15.0	18.8	63	90	10 / 200	20.0	0.60
39614	7/16	17.0	18.8	63	90	10 / 200	20.0	0.60
39616	1/2	18.8	18.8	63	90	10 / 200	20.0	0.60
39618	9/16	22.0	22.0	63	110	10 / 200	25.0	0.60
39619	19/32	22.0	22.0	63	120	10 / 200	25.0	0.60
39620	5/8	23.8	23.8	63	130	10 / 200	27.0	0.60
39622	11/16	24.8	24.8	63	140	10 / 120	18.0	0.35
39624	3/4	27.8	27.8	63	160	10 / 120	21.0	0.35
39625	25/32	27.8	27.8	63	170	10 / 120	21.5	0.52
39626	13/16	29.8	29.8	63	210	10 / 120	27.5	0.52
39628	7/8	31.8	31.8	63	240	10 / 60	16.0	0.45

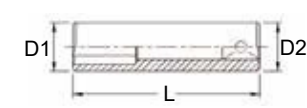
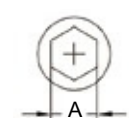

AD-308M 8 Piece 3/8" Dr. Metric Deep Impact Socket Set

Previous Item No.: TF-004

Item No.	Size	Item No.	Size
3/8" Dr. 6pt Deep Impact Socket:			
8mm	13mm		
10mm	14mm		
11mm	17mm		
12mm	19mm		



6 pt.

4x4 16 sets / 16.2 Kgs / 0.71 CUFT

AD-308S 8 Piece 3/8" Dr. SAE Deep Impact Socket Set

Previous Item No.: TF-003

Item No.	Size	Item No.	Size
3/8" Dr. 6pt Deep Impact Socket:			
5/16"	9/16"		
3/8"	5/8"		
7/16"	11/16"		
1/2"	3/4"		



6 pt.

4x4 16 sets / 16.5 Kgs / 0.71 CUFT



Swivel Impact Sockets

Metric Swivel Impact Sockets

Item No.	A mm	D1 mm	D2 mm	Length mm	Weight g	PCS inner/ctn	G.W	CUFT
38008M	8	14	26	53	110	10 / 200		0.60
38009M	9	15	26	53	110	10 / 200	23.0	0.60
38010M	10	16	26	53	110	10 / 200	23.0	0.60
38011M	11	18	26	53	110	10 / 200	23.0	0.60
38012M	12	19	26	53	110	10 / 200	23.0	0.60
38013M	13	20	26	53	110	10 / 200	23.0	0.60
38014M	14	22	26	53	120	10 / 200	23.0	0.60
38015M	15	23	26	53	120	10 / 200	25.0	0.60
38016M	16	24	26	53	120	10 / 200	25.0	0.60
38017M	17	25	26	53	130	10 / 200	25.0	0.60
38018M	18	26	26	53	130	10 / 200	27.0	0.60
38019M	19	28	26	53	130	10 / 200	27.0	0.60



SAE Swivel Impact Sockets

Item No.	A inch	D1 mm	D2 mm	Length mm	Weight g	PCS inner/ctn	G.W	CUFT
38J21	5/16	14	26	53	110	10 / 200		0.60
38022	3/8	15	26	53	110	10 / 200	20.0	0.60
380023	7/16	18	26	53	110	10 / 200	23.0	0.60
38024	1/2	19	26	53	110	10 / 200	23.0	0.60
38025	9/16	22	26	53	120	10 / 200	23.0	0.60
38026	5/8	24	26	53	120	10 / 200	25.0	0.60
38027	11/16	25	26	53	130	10 / 200	25.0	0.60
38028	3/4	28	26	53	130	10 / 200	27.0	0.60

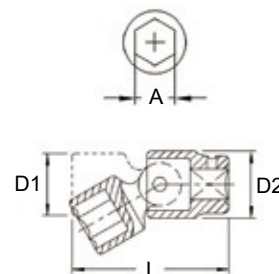

AG-312M 12 Piece 3/8" Dr. Metric Swivel Impact Socket Set

Item No.	Size	Item No.	Size
----------	------	----------	------

3/8" Dr. 6pt Swivel Impact Socket:

8mm	14mm
9mm	15mm
10mm	16mm
11mm	17mm
12mm	18mm
13mm	19mm



1270 g 12x12 sets / 16.5 Kgs / 0.73 CUFT

AG-308S 8 Piece 3/8" Dr. SAE Swivel Impact Socket Set

Item No.	Size	Item No.	Size
----------	------	----------	------

3/8" Dr. 6pt Swivel Impact Socket:

5/16"	9/16"
3/8"	5/8"
7/16"	11/16"
1/2"	3/4"



780 g 12x12 sets / 10.5 Kgs / 0.7 CUFT

Swivel Impact Sockets



Metric Deep Swivel Impact Sockets

Item No.	A mm	D1 mm	D2 mm	Length mm	Weight g	PCS inner/ctn	G.W	CUFT
3808MD	8	14	26	95	210	4 / 80		0.34
3809MD	9	15	26	95	210	4 / 80	18.5	0.34
3810MD	10	16	26	95	210	4 / 80	18.5	0.34
3811MD	11	18	26	95	210	4 / 80	18.5	0.34
3812MD	12	19	26	95	210	4 / 80	18.5	0.34
3813MD	13	20	26	95	210	4 / 80	18.5	0.34
3814MD	14	22	26	95	210	4 / 80	18.5	0.34
3815MD	15	23	26	95	210	4 / 80	18.5	0.34
3816MD	16	24	26	95	210	4 / 80	18.5	0.34
3817MD	17	26	26	95	220	5 / 50	18.5	0.31
3818MD	18	26	26	95	230	5 / 50	13.0	0.31
3819MD	19	28	26	95	250	5 / 50	13.0	0.31



SAE Deep Swivel Impact Sockets

Item No.	A inch	D1 mm	D2 mm	Length mm	Weight g	PCS inner/ctn	G.W	CUFT
3821D	5/16	14	26	95	210	4 / 80		0.34
3822D	3/8	15	26	95	210	4 / 80	18.5	0.34
3823D	7/16	18	26	95	210	4 / 80	18.5	0.34
3824D	1/2	19	26	95	210	4 / 80	18.5	0.34
3825D	9/16	22	26	95	210	4 / 80	18.5	0.34
3826D	5/8	24	26	95	210	4 / 80	18.5	0.34
3827D	11/16	26	26	95	220	5 / 50	18.5	0.31
3828D	3/4	28	26	95	250	5 / 50	12.0	0.31

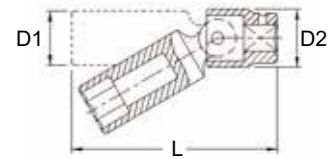
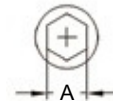

AG-312MD 12 Piece 3/8" Dr. Metric Deep Swivel Impact Socket Set

Item No. Size ItemNo. Size

3/8" Dr. 6pt Deep Swivel Impact Socket:

- 8mm 14mm
- 9mm 15mm
- 10mm 16mm
- 11mm 17mm
- 12mm 18mm
- 13mm 19mm



2690 g

8x1 8 sets / 22.5 Kgs / 0.73 CUFT

AG-308SD 8 Piece 3/8" Dr. SAE Deep Swivel Impact Socket Set

Item No. Size ItemNo. Size

3/8" Dr. 6pt Deep Swivel Impact Socket:

- 5/16" 9/16"
- 3/8" 5/8"
- 7/16" 11/16"
- 1/2" 3/4"



1830 g

12x1 12 sets / 23 Kgs / 0.95 CUFT



Impact Sockets

Metric DeepImpact Sockets

Item No.	A mm	D1 mm	D2 mm	Length mm	Weight g	PCS	G.W	CUFT
						inner/ctn		
46306	6	11.0	18.8	63	65	10 / 200		0.60
46307	7	12.0	18.8	63	65	10 / 200	15.0	0.60
46308	8	13.5	18.8	63	65	10 / 200	15.0	0.60
46309	9	15.0	18.8	63	70	10 / 200	15.0	0.60
46310	10	16.0	18.8	63	75	10 / 200	15.0	0.60
46311	11	17.0	18.8	63	75	10 / 200	17.0	0.60
46312	12	18.8	18.8	63	85	10 / 200	17.0	0.60
46313	13	19.8	19.8	63	85	10 / 200	19.0	0.60
46314	14	22.0	22.0	63	100	10 / 200	19.0	0.60
46315	15	22.0	22.0	63	100	10 / 200	25.0	0.60
46316	16	23.8	22.0	63	120	10 / 200	25.0	0.60
46317	17	24.8	22.0	63	130	10 / 200	27.0	0.60
46318	18	25.8	22.0	63	130	10 / 120	27.0	0.35
46319	19	27.8	22.0	63	150	10 / 120	18.0	0.35
46320	20	27.8	22.0	63	150	10 / 120	19.0	0.52
46321	21	29.8	22.0	63	160	10 / 120	19.0	0.52
46322	22	31.8	22.0	63	180	10 / 60	21.5	0.35
							13.0	



SAE Deep Impact Sockets

Item No.	A inch	D1 mm	D2 mm	Length mm	Weight g	PCS	G.W	CUFT
						inner/ctn		
66308	1/4	11.0	18.8	63	65	10 / 200		0.60
66310	5/16	13.5	18.8	63	65	10 / 200	15.0	0.60
66311	11/32	14.5	18.8	63	65	10 / 200	15.0	0.60
66312	3/8	15.0	18.8	63	70	10 / 200	15.0	0.60
66314	7/16	17.0	18.8	63	75	10 / 200	15.0	0.60
66316	1/2	19.0	18.8	63	85	10 / 200	17.0	0.60
66318	9/16	22.0	22.0	63	100	10 / 200	17.0	0.60
66319	19/32	22.0	22.0	63	100	10 / 200	25.0	0.60
66320	5/8	23.8	22.0	63	120	10 / 200	25.0	0.60
66322	11/16	24.8	22.0	63	130	10 / 200	25.0	0.60
66324	3/4	27.8	22.0	63	150	10 / 120	27.0	0.35
66325	25/32	27.8	22.0	63	150	10 / 120	20.0	0.52
66326	13/16	29.8	22.0	63	160	10 / 120	20.0	0.52
66328	7/8	31.8	22.0	63	180	10 / 60	21.5	0.35
							13.0	

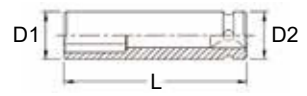
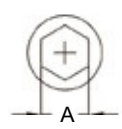

CA-316M 16 Piece 3/8" Dr. Metric Deep Impact Socket Set

Item No.	Size	ItemNo.	Size
3/8" Dr. 6pt Deep Impact Socket:			
7mm	15mm		
8mm	16mm		
9mm	17mm		
10mm	18mm		
11mm	19mm		
12mm	20mm		
13mm	21mm		
14mm	22mm		



2400 g 10x10 sets / 25 Kgs / 0.88 CUFT

CA-313SD 13 Piece 3/8" Dr. SAE Deep Impact Socket Set

Item No.	Size	ItemNo.	Size
3/8" Dr. 6pt Deep Impact Socket:			
5/16"	5/8"		
11/32"	11/16"		
3/8"	3/4"		
7/16"	25/32"		
1/2"	13/16"		
9/16"	7/8"		
19/32"			



2100 g 12x12 sets / 26 Kgs / 0.73 CUFT

Impact Socket Sets

3/8

IA-321M 21 Piece 3/8" Dr. Metric Impact Driver Set

Item No.	Size	Item No.	Size
3/8" Dr. 6pt Impact Socket:			
8mm	13mm		
10mm	14mm		
11mm	17mm		
12mm	19mm		
3/8" Dr. Head Driver, 52mmL:			
1.0 x 5.5mm Slotted		8mm Hex	
1.2 x 8.0mm Slotted		10mm Hex	
1.6 x 10.0mm Slotted		#1 Philips	
5mm Hex 6mm Hex		#2 Philips	
7mm Hex		#3 Philips	
		#4 Philips	

Accessory:

700007	3/8" Dr. Impact Driver	Blow Case
2200 g	10 sets / 23 Kgs / 0.82 CUFT	



SAE size: ID-321S also available

MA-326M 26 Piece 3/8" Dr. Metric Impact Socket Set (CRMO)

Item No.	Size	Item No.	Size
3/8" Dr. 6pt Impact Socket:			
6mm	14mm		
7mm	15mm		
8mm	16mm		
10mm	17mm		
11mm	18mm		
12mm	19mm		
13mm			
3/8" Dr. 6pt Deep Impact Socket:			
6mm	14mm		
7mm	15mm		
8mm	16mm		
10mm	17mm		
11mm	18mm		
12mm	19mm		
13mm			

2400 g	6 sets / 15.5 Kgs / 0.92 CUFT
--------	-------------------------------



CA-326S 26 Piece 3/8" Dr. SAE Impact Socket Set

Item No.	Size	Item No.	Size
3/8" Dr. 6pt Impact Socket:			
5/16"			
11/32"	5/8"		
3/8"	11/16"		
7/16"	3/4"		
1/2"	25/32"		
9/16"	13/16"		
19/32"	7/8"		
3/8" Dr. 6pt Deep Impact Socket:			
5/16"			
11/32"	5/8"		
3/8"	11/16"		
7/16"	3/4"		
1/2"	25/32"		
9/16"	13/16"		
19/32"	7/8"		

2700 g	6 sets / 17.2 Kgs / 0.92 CUFT
--------	-------------------------------





Impact Sockets

Metric Impact Sockets

Item No.	A mm	D1 mm	D2 mm	Length Weight		PCS inner/ctn	G.W.		CUFT
				mm	g		KGS		
13808	8	12.8	23.3	38	75	10 / 200	17.0	0.59	
13809	9	14.0	23.3	38	75	10 / 200	17.0	0.59	
13810	10	14.9	23.3	38	75	10 / 200	17.0	0.59	
13811	11	16.6	23.3	38	75	10 / 200	17.0	0.59	
13812	12	17.8	23.3	38	75	10 / 200	17.0	0.59	
13813	13	18.8	23.3	38	75	10 / 200	17.0	0.59	
13814	14	20.4	23.3	38	75	10 / 200	17.0	0.59	
13815	15	21.5	23.3	38	75	10 / 200	17.0	0.59	
13816	16	23.8	23.8	38	75	10 / 200	17.0	0.59	
13817	17	25.8	25.8	38	95	10 / 200	21.0	0.59	
13818	18	26.8	26.8	38	100	10 / 200	23.0	0.59	
13819	19	27.8	27.8	40	100	10 / 200	23.0	0.59	
13820	20	29.8	29.8	40	120	10 / 150	20.5	0.52	
13821	21	29.8	29.8	40	120	10 / 150	20.5	0.52	
13822	22	31.8	31.8	40	140	10 / 100	16.0	0.62	
13823	23	33.8	33.8	40	150	10 / 100	17.0	0.62	
13824	24	33.8	33.8	40	160	10 / 100	18.0	0.62	
13825	25	35.8	35.8	40	170	10 / 100	19.0	0.62	
13826	26	35.8	35.8	40	180	10 / 100	20.0	0.62	
13827	27	37.8	35.0	40	200	10 / 100	21.0	0.62	
13828	28	39.8	35.0	46	240	10 / 100	26.0	0.62	
13829	29	39.8	35.0	46	240	10 / 100	26.0	0.62	
13830	30	41.8	35.0	46	250	10 / 100	26.0	0.62	
13831	31	43.8	35.0	46	270	10 / 100	29.0	0.62	
13832	32	44.8	35.0	46	280	10 / 100	29.0	0.62	



SAE Impact Sockets

Item No.	A inch	D1 mm	D2 mm	Length Weight		PCS inner/ctn	G.W.		CUFT
				mm	g		KGS		
93810	5/16	12.8	23.3	38	75	10 / 200	17.0	0.59	
93812	3/8	14.7	23.3	38	75	10 / 200	17.0	0.59	
93814	7/16	16.7	23.3	38	75	10 / 200	17.0	0.59	
93816	1/2	18.6	23.3	38	75	10 / 200	17.0	0.59	
93818	9/16	20.6	23.3	38	75	10 / 200	17.0	0.59	
93819	19/32	21.5	23.3	38	75	10 / 200	17.0	0.59	
93820	5/8	23.8	23.8	38	75	10 / 200	17.0	0.59	
93822	11/16	25.8	25.8	38	95	10 / 200	21.0	0.59	
93824	3/4	27.8	27.8	40	100	10 / 200	23.0	0.59	
93825	25/32	29.8	29.8	40	120	10 / 150	21.0	0.52	
93826	13/16	29.8	29.8	40	120	10 / 150	21.0	0.52	
93828	7/8	31.8	31.8	40	140	10 / 150	24.0	0.52	
93830	15/16	33.8	33.8	40	160	10 / 100	18.0	0.62	
93832	1	35.8	35.8	40	170	10 / 100	19.0	0.62	
93834	1-1/16	37.8	35.0	40	200	10 / 100	21.0	0.62	
93836	1-1/8	39.8	35.0	46	240	10 / 100	26.0	0.62	
93838	1-3/16	41.8	35.0	46	250	10 / 100	26.0	0.62	
93840	1-1/4	43.8	35.0	46	280	10 / 100	29.0	0.62	

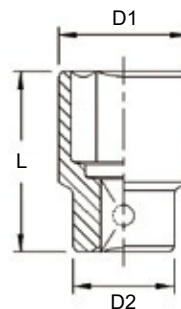

Impact Adapters

Item No.	Female Drive	Male Drive	Length Weight		PCS inner/ctn	G.W.		CUFT
			mm	g				
480033	1/2"	3/8"	38	70	10 / 200		0.59	
480066	1/2"	3/4"	41	110	10 / 200	13.0 28.0	0.59	



Impact Sockets



Metric Deep Impact Sockets

Item No.	A mm	D1 mm	D2 mm	Length mm	Weight g	PCS inner/ctn	G.W .	CUFT
17808	8	12.8	23.3	78	180	10 / 140		0.44
17809	9	14.0	23.3	78	180	10 / 140	26.0	0.44
17810	10	14.9	23.3	78	180	10 / 140	26.0	0.44
17811	11	16.6	23.3	78	180	10 / 140	26.0	0.44
17812	12	17.8	23.3	78	180	10 / 140	26.0	0.44
17813	13	18.8	23.3	78	180	10 / 140	27.5	0.44
17814	14	20.4	23.8	78	190	10 / 140	27.5	0.44
17815	15	21.5	23.3	78	190	10 / 140	27.5	0.44
17816	16	23.8	23.8	78	190	10 / 140	27.5	0.44
17817	17	25.8	25.8	78	200	10 / 120	27.5	0.52
17818	18	26.8	26.8	78	210	10 / 120	28.0	0.52
17819	19	27.8	27.8	78	250	10 / 120	28.0	0.52
17820	20	29.8	29.8	78	270	10 / 120	31.0	0.52
17821	21	29.8	29.8	78	280	10 / 60	33.0	0.45
17822	22	31.8	31.8	78	290	10 / 60	18.5	0.45
17823	23	33.8	33.8	78	320	10 / 60	19.0	0.45
17824	24	34.8	34.8	78	340	10 / 60	22.0	0.45
17825	25	35.8	35.8	78	340	10 / 60	22.0	0.45
17826	26	35.8	35.8	78	350	10 / 60	22.5	0.45
17827	27	38.8	35.0	78	380	10 / 60	22.5	0.45
17828	28	39.8	35.0	78	390	5 / 50	22.5	0.62
17829	29	39.8	35.0	78	400	5 / 50	20.0	0.62
17830	30	41.8	35.0	78	410	5 / 50	21.0	0.62
17831	31	43.8	35.0	78	450	5 / 50	22.0	0.62
17832	32	44.8	35.0	78	460	5 / 50	23.5 24.0	0.62



SAE Deep Impact Sockets

Item No.	A inch	D1 mm	D2 mm	Length mm	Weight g	PCS inner/ctn	G.W .	CUFT
97810	5/16	12.8	23.3	78	180	10 / 140		0.44
97812	3/8	14.7	23.8	78	180	10 / 140	26.0	0.44
97814	7/16	16.7	23.3	78	180	10 / 140	26.0	0.44
97816	1/2	18.6	23.3	78	190	10 / 140	26.0	0.44
97818	9/16	20.6	23.3	78	190	10 / 140	27.5	0.44
97819	19/32	21.5	23.3	78	190	10 / 140	27.5	0.44
97820	5/8	23.8	23.8	78	190	10 / 120	27.5	0.52
97822	11/16	25.8	25.8	78	200	10 / 120	27.5	0.52
97824	3/4	27.8	27.8	78	250	10 / 120	28.0	0.52
97825	25/32	29.8	29.8	78	270	10 / 120	31.0	0.52
97826	13/16	29.8	29.8	78	280	10 / 60	33.0	0.45
97828	7/8	31.8	31.8	78	290	10 / 60	18.5	0.45
97830	15/16	33.8	33.8	78	340	10 / 60	19.0	0.45
97832	1	35.8	35.8	78	340	10 / 60	22.0	0.45
97834	1-1/16	38.8	35.0	78	380	10 / 60	22.5	0.45
97836	1-1/8	39.8	35.0	78	400	5 / 50	24.0	0.62
97838	1-3/16	41.8	35.0	78	410	5 / 50	21.0	0.62
497840	1-1/4	43.8	35.0	78	460	5 / 50	22.0 24.0	0.62

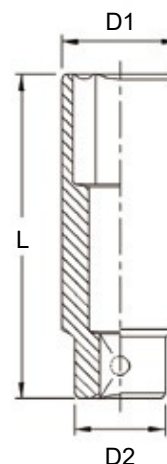
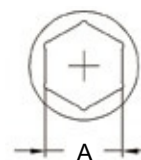



Impact Socket Sets

TA-410M1 10Piece 1/2" Dr. Metric Deep Impact Socket Set

Item No.	Size	ItemNo.	Size
1/2" Dr. 6pt Deep Impact Socket:			
10mm	17mm		
12mm	19mm		
13mm	21mm		
14mm	22mm		
16mm	24mm		

2530 g 10 sets / 26.3 Kgs / 0.52 CUFT



AT-410M 10 Piece 1/2" Dr. Metric Deep Impact Socket Set

Item No.	Size	ItemNo.	Size
1/2" Dr. 6pt Deep Impact Socket:			
11mm	17mm		
12mm	19mm		
13mm	21mm		
14mm	22mm		
16mm	24mm		

2530 g 10 sets / 26.3 Kgs / 0.52 CUFT



AD-410S 10 Piece 1/2" Dr. SAE Deep Impact Socket Set

Item No.	Size	ItemNo.	Size
1/2" Dr. 6pt Deep Impact Socket:			
7/16"	3/4"		
1/2"	13/16"		
9/16"	7/8"		
5/8"	15/16"		
11/16"	1"		

2830 g 10 sets / 29.3 Kgs / 0.52 CUFT



AF-417MB 1/2" Dr. 17 Piece Metric Impact Socket Set

Item No.	Size	ItemNo.	Size
1/2" Dr. 6pt Impact Socket(CRV):			
8mm	18mm		
10mm	19mm		
11mm	21mm		
12mm	22mm		
13mm	24mm		
14mm	27mm		
15mm	30mm		
16mm	32mm		
17mm			

2420 g 8 sets / 20.3 Kgs / 0.94 CUFT





Impact Socket Sets

AD-416M 16Piece 1/2" Dr. Metric Deep Impact Socket Set

Item No.	Size	ItemNo.	Size
1/2" Dr. 6pt Deep Impact Socket:			
10mm	18mm		
11mm	19mm		
12mm	20mm		
13mm	21mm		
14mm	22mm		
15mm	24mm		
16mm	27mm		
17mm	30mm		

4300 g 6 sets / 27 Kgs / 1.58 CUFT



6 pt.

AD-416M1 16 Piece 1/2" Dr. Metric Deep Impact Socket Set

Item No.	Size	ItemNo.	Size
1/2" Dr. 6pt Deep Impact Socket:			
10mm	18mm		
11mm	19mm		
12mm	21mm		
13mm	22mm		
14mm	24mm		
15mm	27mm		
16mm	30mm		
17mm	32mm		

4350 g 6 sets / 27.3 Kgs / 1.58 CUFT



6 pt.

AD-416S 16 Piece 1/2" Dr. SAE Deep Impact Socket Set

Item No.	Size	ItemNo.	Size
1/2" Dr. 6pt Deep Impact Socket:			
5/16"	13/16"		
3/8"	7/8"		
7/16"	15/16"		
1/2"	1"		
9/16"	1-1/16"		
5/8"	1-1/8"		
11/16"	1-3/16"		
3/4"	1-1/4"		

4650 g 6 sets / 29 Kgs / 1.58 CUFT



6 pt.



Impact Socket Sets

AS-435I 35Piece 1/2" Dr. Metric Deep Impact Socket Set

Item No.	Size	ItemNo.	Size	Item No.	Size
1/2" Dr. 6pt Impact Socket (CR-V):			1/2" Dr. Accessory:		
10mm	19mm				
12mm	21mm				
13mm	22mm	Impact Extension Bar,	50mmL		
14mm	24mm	Impact Extension Bar,	75mmL		
15mm	27mm	Impact Extension Bar,	125mmL		
16mm	30mm	Impact Extension Bar,	250mmL		
17mm	32mm	Impact Universal Joint			
18mm					



1/2" Dr. 6pt Deep Impact Socket (CR-V):

10mm	19mm
12mm	21mm
13mm	22mm
14mm	24mm
15mm	27mm
16mm	30mm
17mm	32mm
18mm	

7100 g 3 sets / 23 Kgs / 1.35 CUFT

AF-425M 25 Piece 1/2" Dr. Metric Impact Socket Set

(285W x 410D x 50H)

Item No.	Size	ItemNo.	Size
1/2" Dr. 6pt Impact Socket (CR-V):			

8mm	21mm
9mm	22mm
10mm	23mm
11mm	24mm
12mm	25mm
13mm	26mm
14mm	27mm
15mm	28mm
16mm	29mm
17mm	30mm
18mm	31mm
19mm	32mm
20mm	

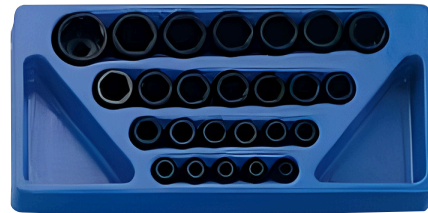

(192W x 406D)



3700 g 3 sets / 13 Kgs / 0.82 CUFT

TDD-424M 24 Piece 1/2" Dr. Metric Deep Impact Socket Set

Item No.	Size	ItemNo.	Size
1/2" Dr. 6pt Deep Impact Socket (CR-V):			

8mm	20mm
9mm	21mm
10mm	22mm
11mm	23mm
12mm	24mm
13mm	25mm
14mm	26mm
15mm	27mm
16mm	28mm
17mm	30mm
18mm	31mm
19mm	32mm

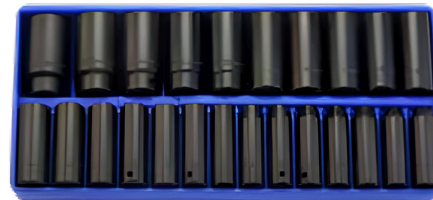

(192W x 406D)



Swivel Impact Sockets



Metric Swivel Impact Sockets

Item No.	A mm	D1 mm	D2 mm	Length mm	Weight g	PCS inner/ctn	G.W	CUFT
4811M	11	19	28	66	150	5 / 100		0.39
4812M	12	20	28	66	150	5 / 100	16.0	0.39
4813M	13	20	28	66	150	5 / 100	16.0	0.39
4814M	14	22	28	66	160	5 / 100	16.0	0.39
4815M	15	24	28	66	160	5 / 100	17.0	0.39
4816M	16	24	28	66	170	5 / 100	17.0	0.39
4817M	17	26	32	66	190	4 / 80	18.0	0.39
4818M	18	26	32	66	220	4 / 80	16.0	0.39
4819M	19	28	32	66	230	4 / 80	18.5	0.39
4821M	21	30	32	66	240	4 / 80	19.5	0.39
4822M	22	32	32	66	250	4 / 80	20.5	0.39
							21.0	



SAE Swivel Impact Sockets

Item No.	A inch	D1 mm	D2 mm	Length mm	Weight g	PCS inner/ctn	G.W	CUFT
480J24	7/16	19	28	66	150	5 / 100		0.39
48025	1/2	20	28	66	150	5 / 100	17.0	0.39
48026	9/16	22	28	66	160	5 / 100	17.0	0.39
48027	5/8	24	28	66	170	5 / 100	18.0	0.39
48028	11/16	26	32	66	230	4 / 80	19.0	0.39
48029	3/4	28	32	66	240	4 / 80	20.0	0.39
48030	13/16	30	32	66	250	4 / 80	21.0	0.39
48031	7/8	32	32	66	260	4 / 80	22.0	0.39
							22.0	

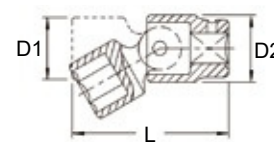
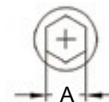

Metric Semi-Deep Swivel Impact Sockets

Item No.	A mm	D1 mm	D2 mm	Length mm	Weight g	PCS inner/ctn	G.W	CUFT
87911M	11	18	28	80	180	4 / 80		0.31
87912M	12	19	28	80	180	4 / 80	15.5	0.31
87913M	13	21	28	80	180	4 / 80	15.5	0.31
87914M	14	22	28	80	190	4 / 80	15.5	0.31
87915M	15	23	28	80	190	4 / 80	16.0	0.31
87916M	16	24	28	80	200	4 / 80	16.0	0.31
87917M	17	26	32	80	270	5 / 50	17.0	0.43
87918M	18	26	32	80	290	5 / 50	14.5	0.43
87919M	19	28	32	80	290	5 / 50	15.5	0.43
87921M	21	30	32	80	300	5 / 50	15.5	0.43
87922M	22	32	32	80	310	5 / 50	16.0	0.43
							16.5	



SAE Semi-Deep Swivel Impact Sockets

Item No.	A inch	D1 mm	D2 mm	Length mm	Weight g	PCS inner/ctn	G.W	CUFT
48814	7/16	19	28	80	180	4 / 80		0.31
48816	1/2	20	28	80	180	4 / 80	15.5	0.31
48818	9/16	22	28	80	190	4 / 80	15.5	0.31
48820	5/8	24	28	80	200	4 / 80	16.0	0.31
48822	11/16	26	32	80	270	5 / 50	17.0	0.31
48824	3/4	28	32	80	290	5 / 50	14.5	0.43
48826	13/16	30	32	80	300	5 / 50	15.5	0.43
48828	7/8	32	32	80	310	5 / 50	16.0	0.43
							16.5	

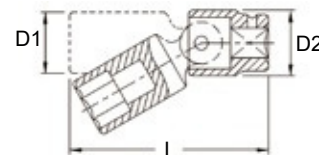
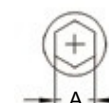

AG-411M 11 Piece 1/2" Dr. Metric Swivel Impact Socket Set

Item No.	Size	ItemNo.	Size
1/2" Dr. 6pt Swivel Impact Socket, 66mmL:			
11mm			
12mm	17mm		
13mm	18mm		
14mm	19mm		
15mm	21mm		
16mm	22mm		
		SocketHolder	



2250 g

12 sets / 28 Kgs / 0.73 CUFT

Metric Impact Sockets

Item No.	A mm	D1 mm	D2 mm	Length mm	Weight g	PCS inner/ctn	G.W	CUFT
44008	8	14.7	23.3	38	70	10 / 200	.	0.59
44009	9	15.9	23.3	38	70	10 / 200	16.0	0.59
44010	10	17.2	23.3	38	70	10 / 200	16.0	0.59
44011	11	18.4	23.3	38	70	10 / 200	16.0	0.59
44012	12	19.7	23.3	38	70	10 / 200	16.0	0.59
44013	13	20.9	23.3	38	70	10 / 200	16.0	0.59
444014	14	22.2	23.3	38	70	10 / 200	16.0	0.59
44015	15	23.3	23.3	38	70	10 / 200	16.0	0.59
44016	16	23.8	23.8	38	70	10 / 200	16.0	0.59
44017	17	25.8	25.8	38	85	10 / 200	16.0	0.59
44018	18	26.8	26.8	38	90	10 / 200	19.0	0.59
44019	19	27.8	27.8	40	100	10 / 200	20.0	0.59
44020	20	29.8	29.8	40	120	10 / 150	22.0	0.52
44021	21	29.8	29.8	40	120	10 / 150	20.0	0.52
44022	22	31.8	30.0	42	130	10 / 150	20.0	0.52
44023	23	33.8	30.0	42	150	10 / 150	21.5	0.52
44024	24	34.8	30.0	44	160	10 / 150	24.5	0.52
44025	25	35.8	30.0	44	170	10 / 100	26.0	0.62
44026	26	35.8	30.0	44	180	10 / 100	19.0	0.62
44027	27	38.8	30.0	46	190	10 / 100	20.0	0.62
44028	28	39.8	30.0	46	200	10 / 100	21.0	0.62
44029	29	39.8	30.0	46	200	10 / 100	22.0	0.62
44030	30	41.8	31.0	46	210	10 / 100	22.0	0.62
44031	31	43.8	31.0	46	230	10 / 100	23.0	0.62
44032	32	45.5	31.0	46	240	10 / 100	25.0	0.62
44033	33	45.8	35.0	46	270	10 / 100	26.0	0.62
44034	34	47.7	35.0	46	300	5 / 50	29.0	0.41
44035	35	48.0	35.0	48	310	5 / 30	16.0	0.34
44036	36	50.0	35.0	48	330	5 / 30	10.5	0.34
44037	37	50.0	35.0	48	330	5 / 30	11.0	0.34
44038	38	52.7	35.0	48	350	5 / 30	11.0	0.34
44039	39	53.8	35.0	50	360	5 / 30	11.5	0.34
44040	40	55.0	35.0	55	410	5 / 30	12.0	0.34
44041	41	56.5	35.0	55	440	5 / 30	13.5	0.34
							14.5	

6 pt.



SAE Impact Sockets

Item No.	A inch	D1 mm	D2 mm	Length mm	Weight g	PCS inner/ctn	G.W	CUFT
4010	5/16	14.7	23.3	38	70	10 / 200	.	0.59
4012	3/8	16.5	23.3	38	70	10 / 200	16.0	0.59
4014	7/16	18.4	23.3	38	70	10 / 200	16.0	0.59
4016	1/2	20.4	23.3	38	70	10 / 200	16.0	0.59
4018	9/16	22.4	23.3	38	70	10 / 200	16.0	0.59
4019	19/32	23.3	23.3	38	70	10 / 200	16.0	0.59
4020	5/8	23.8	23.8	38	70	10 / 200	16.0	0.59
4022	11/16	25.8	25.8	38	90	10 / 200	16.0	0.59
4024	3/4	27.8	27.8	40	100	10 / 200	20.0	0.59
4025	25/32	29.8	29.8	40	120	10 / 150	22.0	0.52
4026	13/16	29.8	29.8	40	130	10 / 150	20.0	0.52
4028	7/8	31.8	30.0	42	130	10 / 150	21.5	0.52
4030	15/16	33.8	30.0	44	160	10 / 150	21.5	0.52
4032	1	35.8	30.0	44	180	10 / 100	26.0	0.62
4034	1-1/16	38.8	30.0	46	190	10 / 100	20.0	0.62
4036	1-1/8	39.8	30.0	46	200	10 / 100	21.0	0.62
4038	1-3/16	41.8	30.0	46	210	10 / 100	22.0	0.62
4040	1-1/4	43.8	30.0	46	240	10 / 100	23.0	0.62
4042	1-5/16	46.0	35.0	46	270	5 / 50	26.0	0.41
4044	1-3/8	48.0	35.0	48	310	5 / 30	15.0	0.34
4046	1-7/16	49.0	35.0	48	330	5 / 30	10.5	0.34
4048	1-1/2	52.8	35.0	48	350	5 / 30	11.0	0.34
4050	1-9/16	54.8	35.0	55	410	5 / 30	11.5	0.34
4052	1-5/8	56.8	35.0	55	440	5 / 30	13.0	0.34
							13.5	

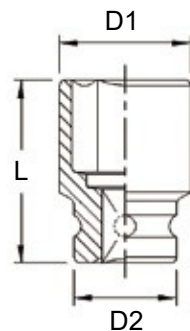
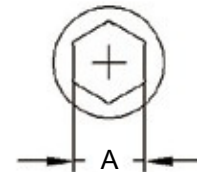



Impact Sockets

Metric Deep Impact Sockets

*Thin Wall

Item No.	A mm	D1 mm	D2 mm	Length mm	Weight g	PCS inner/ctn	G.W. KGS	CUFT
47808	8	14.7	23.8	78	130	10 / 140	21.0	0.44
47809	9	15.9	23.8	78	140	10 / 140	21.0	0.44
47810	10	17.2	23.8	78	140	10 / 140	21.0	0.44
47811	11	18.4	23.8	78	140	10 / 140	21.0	0.44
47812	12	19.7	23.8	78	140	10 / 140	21.0	0.44
47813	13	20.9	23.8	78	150	10 / 140	21.0	0.44
47814	14	22.2	23.8	78	150	10 / 140	22.0	0.44
47814T	14	20.5	23.8	78	140	10 / 140	21.0	0.44
47815	15	23.8	23.8	78	160	10 / 140	23.5	0.44
47816	16	23.8	23.8	78	170	10 / 140	25.0	0.44
47817	17	25.8	25.8	78	180	10 / 120	24.0	0.52
47817T	17	23.8	23.8	78	150	10 / 120	19.5	0.52
47818	18	26.8	26.8	78	190	10 / 120	25.0	0.52
47819	19	27.8	27.8	78	230	10 / 120	30.0	0.52
47819T	19	26.2	26.2	78	170	10 / 120	21.5	0.52
47820	20	29.8	29.8	78	240	10 / 120	30.0	0.52
447821	21	29.8	29.8	78	250	10 / 60	16.0	0.45
47821T	21	28.5	29.8	78	220	10 / 60	14.5	0.45
47822	22	31.8	30.0	78	260	10 / 60	17.0	0.45
47823	23	33.8	30.0	78	300	10 / 60	19.0	0.45
47824	24	34.8	30.0	78	300	10 / 60	19.0	0.45
47825	25	35.8	30.0	78	300	10 / 60	19.5	0.45
47826	26	35.8	30.0	78	310	10 / 60	20.0	0.45
47827	27	38.8	30.0	78	340	10 / 60	22.0	0.45
47828	28	39.8	30.0	78	350	5 / 50	19.0	0.62
47829	29	39.8	30.0	78	360	5 / 50	19.5	0.62
47830	30	41.8	31.0	78	380	5 / 50	20.0	0.62
47831	31	43.8	31.0	78	440	5 / 50	24.0	0.62
47832	32	44.8	31.0	78	460	5 / 50	24.5	0.62
47833	33	45.8	35.0	78	480	5 / 50	26.0	0.62
47834	34	47.8	35.0	78	510	5 / 50	27.0	0.62
47835	35	47.8	35.0	78	520	5 / 50	28.0	0.62
47836	36	50.0	35.0	78	530	5 / 50	29.0	0.62
47837	37	50.0	35.0	78	530	1 / 30	18.0	0.52
47838	38	52.7	35.0	78	570	1 / 30	19.0	0.52
47839	39	53.8	35.0	78	580	1 / 30	19.0	0.52
47840	40	55.0	35.0	78	590	1 / 30	19.0	0.52
47841	41	56.5	35.0	78	600	1 / 30	19.5	0.52
47846	46	62.0	35.0	78	665	1 / 10	9.0	0.31

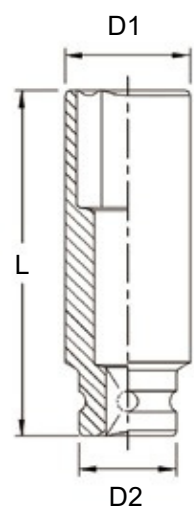
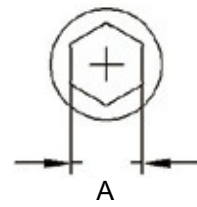

SAE Deep Impact Sockets

Item No.	A inch	D1 mm	D2 mm	Length mm	Weight g	PCS inner/ctn	G.W. KGS	CUFT
47810	5/16	14.7	23.8	78	130	10 / 140	21.0	0.44
47812	3/8	16.5	23.8	78	140	10 / 140	21.0	0.44
47814	7/16	18.4	23.8	78	140	10 / 140	21.0	0.44
47816	1/2	20.4	23.8	78	150	10 / 140	21.0	0.44
47818	9/16	22.4	23.8	78	150	10 / 140	22.0	0.44
47819	19/32	23.8	23.8	78	160	10 / 140	22.5	0.44
47820	5/8	23.8	23.8	78	170	10 / 140	25.0	0.44
47822	11/16	25.8	25.8	78	190	10 / 120	25.0	0.52
47824	3/4	27.8	27.8	78	230	10 / 120	30.0	0.52
47825	25/32	29.8	29.8	78	250	10 / 120	31.0	0.52
47826	13/16	29.8	29.8	78	260	10 / 120	32.0	0.52
47828	7/8	31.8	30.0	78	260	10 / 60	17.0	0.45
47830	15/16	33.8	30.0	78	300	10 / 60	19.5	0.45
47832	1	35.8	30.0	78	300	10 / 60	20.0	0.45
47834	1-1/16	38.8	30.0	78	340	10 / 60	22.0	0.45
47836	1-1/8	39.8	30.0	78	360	5 / 50	19.5	0.62
47838	1-3/16	41.8	30.0	78	380	5 / 50	20.0	0.62
47840	1-1/4	43.8	30.0	78	460	5 / 50	24.0	0.62
47842	1-5/16	45.8	35.0	78	480	5 / 50	25.5	0.62
47844	1-3/8	47.8	35.0	78	510	5 / 50	27.0	0.62
47846	1-7/16	50.0	35.0	78	530	1 / 30	18.0	0.52
47848	1-1/2	52.8	35.0	78	570	1 / 30	19.0	0.52
47850	1-9/16	54.8	35.0	78	590	1 / 30	19.0	0.52
47852	1-5/8	56.8	35.0	78	600	1 / 30	19.5	0.52
47858	1-13/16	62.0	35.0	78	665	1 / 10	9.0	0.31



Thin Wall Impact Sockets

Metric ThinWallImpact Sockets (12-Point)

Item No.	A mm	D1 mm	D2 mm	Length mm	Weight g	PCS inner/ctn	G.W. KGS	CUFT
53808	8	14.0	23.3	38	50	10 / 200	13.0	0.59
53809	9	15.0	23.3	38	55	10 / 200	13.0	0.59
53810	10	16.0	23.3	38	55	10 / 200	13.0	0.59
53811	11	17.0	23.3	38	55	10 / 200	13.0	0.59
53812	12	19.0	23.3	38	55	10 / 200	13.0	0.59
53813	13	20.0	23.3	38	60	10 / 200	14.0	0.59
53814	14	21.0	23.3	38	60	10 / 200	14.0	0.59
53815	15	22.0	23.3	38	60	10 / 200	14.0	0.59
53816	16	23.0	23.8	38	65	10 / 200	15.0	0.59
53817	17	23.8	23.8	38	65	10 / 200	15.0	0.59
53818	18	25.8	25.8	38	80	10 / 200	18.0	0.59
53819	19	26.8	26.8	40	85	10 / 200	19.0	0.59
53820	20	27.8	27.8	40	95	10 / 150	16.0	0.52
53821	21	29.8	29.8	40	100	10 / 150	17.5	0.52
53822	22	29.8	29.0	42	120	10 / 150	20.5	0.52
53823	23	31.8	30.0	42	130	10 / 150	20.5	0.52
53824	24	32.8	30.0	44	140	10 / 150	22.0	0.52
53825	25	33.8	30.0	44	140	10 / 100	16.0	0.62
53826	26	35.8	30.0	44	150	10 / 100	16.0	0.62
53827	27	36.8	30.0	46	160	10 / 100	18.0	0.62
53828	28	37.8	30.0	46	160	10 / 100	18.0	0.62
53829	29	37.8	30.0	46	170	10 / 100	18.0	0.62
53830	30	40.8	30.0	46	180	10 / 100	20.0	0.62
53831	31	41.8	30.0	46	180	10 / 100	20.0	0.62
53832	32	42.8	30.0	46	190	10 / 100	21.0	0.62
53833	33	43.8	35.0	46	220	10 / 100	24.0	0.62
53834	34	46.0	35.0	46	250	5 / 50	13.5	0.41
53835	35	46.0	35.0	48	260	5 / 30	9.0	0.34
53836	36	48.0	35.0	48	270	5 / 30	9.5	0.34
53837	37	48.0	35.0	48	290	5 / 30	10.0	0.34
53838	38	51.0	35.0	48	300	5 / 30	10.0	0.34
53839	39	52.0	35.0	50	320	5 / 30	11.0	0.34
53840	40	53.0	35.0	55	380	5 / 30	12.5	0.34
53841	41	54.0	35.0	55	380	5 / 30	13.0	0.34

12
pt.

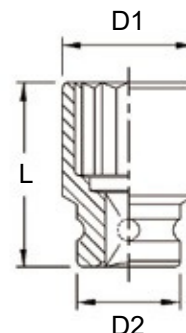

Metric Semi-Deep Thin Wall Impact Sockets

Item No.	A mm	D1 mm	D2 mm	Length mm	Weight g	PCS inner/ctn	G.W.	CUFT
45210	10	16.0	23.8	52	80	10 / 140		0.44
45211	11	17.0	23.8	52	80	10 / 140	12.0	0.44
45212	12	19.0	23.8	52	80	10 / 140	12.0	0.44
45213	13	20.0	23.8	52	90	10 / 140	13.5	0.44
45214	14	21.0	23.8	52	90	10 / 140	13.5	0.44
45215	15	22.0	23.8	52	100	10 / 140	13.5	0.44
45216	16	23.0	23.8	52	100	10 / 140	15.5	0.44
45217	17	23.8	23.8	52	100	10 / 140	15.5	0.44
45218	18	25.8	25.8	52	110	10 / 150	15.5	0.69
45219	19	27.8	27.8	52	120	10 / 150	18.0	0.69
45220	20	27.8	27.8	52	140	10 / 120	19.5	0.52
45221	21	29.8	29.8	52	150	10 / 120	18.5	0.52
45222	22	29.8	29.8	52	170	10 / 120	19.5	0.52
45223	23	31.8	31.8	52	190	10 / 120	22.5	0.52
45224	24	33.8	33.8	52	200	10 / 120	24.0	0.52
							25.0	

6
pt.

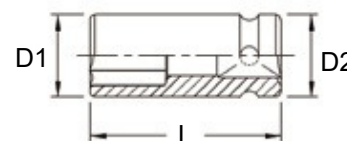
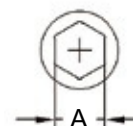

Thin Wall Impact Sockets

1/2"

Metric Deep Thin Wall Impact Sockets (12-Point)

Item No.	A mm	D1 mm	D2 mm	Length mm	Weight g	PCS inner/ctn	G.W	CUFT
48508	8	14.0	23.8	85	100	10 / 140		0.44
48509	9	15.0	23.8	85	100	10 / 140	15.0	0.44
48510	10	16.0	23.8	85	120	10 / 140	15.0	0.44
48511	11	17.0	23.8	85	120	10 / 140	18.0	0.44
48512	12	19.0	23.8	85	130	10 / 140	18.0	0.44
48513	13	20.0	23.8	85	130	10 / 140	19.0	0.44
48514	14	21.0	23.8	85	140	10 / 140	19.0	0.44
48515	15	22.0	23.8	85	150	10 / 140	20.5	0.44
48516	16	23.8	23.8	85	160	10 / 140	22.0	0.44
48517	17	23.8	23.8	85	180	10 / 120	23.5	0.52
48518	18	25.8	25.8	85	190	10 / 120	22.5	0.52
48519	19	27.8	27.8	85	200	10 / 120	24.0	0.52
48520	20	27.8	27.8	85	230	10 / 120	25.0	0.52
48521	21	29.8	29.8	85	240	10 / 60	28.5	0.45
48522	22	29.8	29.8	85	260	10 / 60	15.5	0.45
48523	23	31.8	30.0	85	280	10 / 60	16.5	0.45
48524	24	33.8	30.0	85	300	10 / 60	18.0	0.45
48525	25	34.0	30.0	85	290	10 / 60	19.0	0.45
48526	26	36.0	30.0	85	310	10 / 60	18.5	0.45
48527	27	37.0	30.0	85	340	10 / 60	19.5	0.45
48528	28	38.0	30.0	85	360	6 / 60	21.5	0.62
48529	29	39.0	30.0	85	370	6 / 60	22.5	0.62
48530	30	41.0	30.0	85	390	5 / 50	23.0	0.62
48531	31	42.0	30.0	85	410	5 / 50	21.5	0.62
48532	32	43.0	30.0	85	420	5 / 50	21.5	0.62
48533	33	44.0	35.0	85	450	5 / 50	22.0	0.62
48534	34	46.0	35.0	85	490	5 / 50	23.5	0.62
48535	35	47.0	35.0	85	500	5 / 50	24.5	0.62
48536	36	48.0	35.0	85	550	1 / 30	25.5	0.52
48537	37	49.0	35.0	85	560	1 / 30	17.5	0.52
48538	38	51.0	35.0	85	570	1 / 30	18.0	0.52
48539	39	52.0	35.0	85	580	1 / 30	18.0	0.52
48540	40	53.0	35.0	85	620	1 / 30	19.0	0.52
48541	41	55.0	35.0	85	630	1 / 30	19.5	0.52



12 pt.

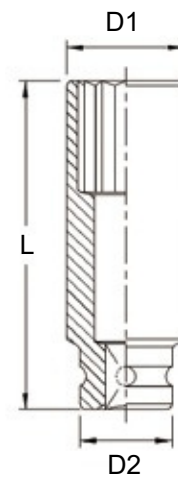
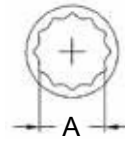

CDA-440M

40Piece 1/2" Dr. Metric Master Impact Socket Set

Item No. Size Item No. Size

1/2" Dr. 6pt Impact Socket:

9mm	19mm
10mm	20mm
11mm	21mm
12mm	22mm
13mm	23mm
14mm	24mm
15mm	26mm
16mm	27mm
17mm	30mm
18mm	

1/2" Dr. 6pt Deep Impact Socket:

9mm	19mm
10mm	20mm
11mm	21mm
12mm	22mm
13mm	23mm
14mm	24mm
15mm	26mm
16mm	27mm
17mm	30mm
18mm	

1/2" Dr. Accessory:

Impact Universal Joint
Impact Extension Bar, 125mmL



Metric Impact Sockets

Item No.	A mm	D1 mm	D2 mm	Length mm	Weight g	PCS inner/ctn	G.W	CUFT
64217	17	29.0	38	51	220	5 / 50		0.34
64218	18	31.0	38	51	230	5 / 50	12.5	0.34
64219	19	32.0	38	51	240	5 / 50	12.5	0.34
64220	20	33.0	38	51	250	5 / 50	13.0	0.34
64221	21	35.0	38	51	250	5 / 50	13.5	0.34
64222	22	36.0	40	51	290	5 / 50	14.0	0.34
64223	23	38.0	40	51	290	5 / 50	16.0	0.34
64224	24	39.0	40	51	300	5 / 50	16.0	0.34
64225	25	40.0	40	54	330	5 / 50	16.5	0.34
64226	26	41.0	41	54	340	5 / 50	17.5	0.34
64227	27	42.0	42	54	350	5 / 50	18.5	0.41
64228	28	44.0	44	54	380	5 / 50	18.5	0.41
64229	29	45.0	44	54	390	5 / 50	20.5	0.41
64230	30	46.0	44	54	400	5 / 50	21.0	0.41
64231	31	48.0	44	54	430	5 / 30	21.5	0.34
64232	32	49.0	44	57	460	5 / 30	14.0	0.34
64233	33	50.0	44	57	460	5 / 30	15.0	0.34
64234	34	51.0	44	57	470	5 / 30	15.0	0.34
64235	35	53.0	44	57	500	5 / 30	15.5	0.34
64236	36	54.0	44	57	510	5 / 30	16.0	0.34
64237	37	55.0	44	57	520	5 / 30	16.5	0.34
64238	38	56.0	44	57	520	5 / 30	16.5	0.34
64239	39	57.0	44	58	570	5 / 30	16.5	0.34
64240	40	59.0	44	58	580	1 / 20	18.0	0.39
64241	41	60.0	44	58	600	1 / 20	12.5	0.39
64242	42	61.0	44	61	630	1 / 20	13.0	0.39
64243	43	62.0	44	61	630	1 / 20	13.5	0.39
64244	44	64.0	44	63	690	1 / 20	13.5	0.39
64245	45	65.0	44	63	690	1 / 20	15.0	0.39
64246	46	66.0	44	63	730	1 / 20	15.0	0.39
64247	47	67.0	44	64	770	1 / 20	16.0	0.39
64248	48	69.0	44	65	790	1 / 20	16.5	0.39
64249	49	70.0	44	65	840	1 / 20	17.0	0.39
64250	50	71.0	44	68	870	1 / 20	18.0	0.39
64251	51	72.0	44	68	870	1 / 10	19.0	0.43
64252	52	74.0	54	70	1080	1 / 10	10.0	0.43
64253	53	75.0	54	70	1100	1 / 10	12.0	0.43
64254	54	76.0	54	73	1200	1 / 10	12.0	0.43
64255	55	78.0	54	73	1240	1 / 10	13.0	0.43
64256	56	79.0	54	73	1240	1 / 10	13.5	0.43
64257	57	80.0	54	73	1290	1 / 10	13.5	0.43
64258	58	81.0	54	73	1330	1 / 10	14.0	0.43
64259	59	83.0	60	73	1400	1 / 10	14.5	0.43
64260	60	84.0	60	80	1580	1 / 10	15.0	0.43
64261	61	85.0	60	80	1580	1 / 10	17.0	0.43
64262	62	86.0	60	80	1600	1 / 10	17.0	0.43
64263	63	88.0	60	80	1680	1 / 10	17.0	0.43
64264	64	89.0	60	80	1720	1 / 6	18.0	0.41
64265	65	90.0	60	85	1820	1 / 6	11.5	0.41
64266	66	90.5	60	85	1830	1 / 6	12.0	0.41
		92.0	60	85	1840	1 / 6	12.0	0.41
64267	67	94.0	60	85	1840	1 / 6	12.0	0.41
64268	68	94.5	60	85	1960	1 / 6	12.0	0.41
64269	69	96.0	60	90	2140	1 / 6	13.0	0.41
64270	70	97.5	60	90	2170	1 / 6	14.0	0.41
64271	71	99.0	60	90	2200	1 / 6	14.0	0.41
64272	72	99.5	60	90	2230	1 / 6	14.0	0.41
64273	73	101.0	60	90	2250	1 / 6	14.5	0.41
64274	74	102.0	60	90	2270	1 / 6	14.5	0.41
64275	75	103.5	60	90	2340	1 / 6	14.5	0.41
64276	76						15.0	

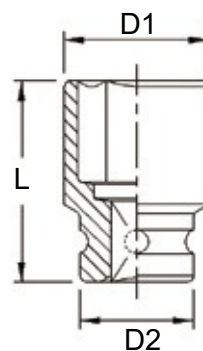
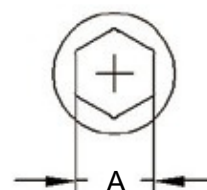



SAE ImpactSockets

Item No.	A	D1	D2	Length	Weight	PCS	G.W	CUFT
	inch	mm	mm	mm	g	inner/ctn		
66222	11/16	30	38	51	230	5 / 50		0.34
66224	3/4	32	38	51	240	5 / 50	13.0	0.34
66225	25/32	33	38	51	250	5 / 50	13.0	0.34
66226	13/16	35	38	51	250	5 / 50	13.5	0.34
66228	7/8	36	40	51	290	5 / 50	14.0	0.34
66230	15/16	39	40	51	300	5 / 50	16.0	0.34
66232	1	40	40	54	330	5 / 50	16.5	0.34
66234	1-1/16	42	42	54	350	5 / 50	17.5	0.41
66236	1-1/8	45	44	54	390	5 / 50	18.5	0.41
66238	1-3/16	46	44	54	400	5 / 50	21.0	0.41
66240	1-1/4	49	44	57	460	5 / 30	21.5	0.34
66242	1-5/16	50	44	57	460	5 / 30	15.0	0.34
66244	1-3/8	53	44	57	500	5 / 30	15.0	0.34
66246	1-7/16	54	44	57	510	5 / 30	16.0	0.34
66248	1-1/2	56	44	57	520	5 / 30	16.5	0.34
66250	1-9/16	59	44	58	580	1 / 20	16.5	0.39
66252	1-5/8	60	44	58	600	1 / 20	12.5	0.39
66254	1-11/16	63	44	61	630	1 / 20	13.0	0.39
66256	1-3/4	65	44	63	730	1 / 20	13.5	0.39
66258	1-13/16	66	44	63	730	1 / 20	16.0	0.39
66260	1-7/8	69	44	65	800	1 / 20	16.0	0.39
66262	1-15/16	70	44	65	840	1 / 20	17.0	0.39
66264	2	72	44	68	840	1 / 20	18.0	0.39
66266	2-1/16	74	54	70	1080	1 / 10	18.0	0.43
66268	2-1/8	76	54	73	1200	1 / 10	12.0	0.43
66270	2-3/16	78	54	73	1240	1 / 10	13.0	0.43
66272	2-1/4	80	54	73	1290	1 / 10	13.5	0.43
66274	2-5/16	83	60	73	1400	1 / 10	14.0	0.43
66276	2-3/8	84	60	80	1580	1 / 10	15.0	0.43
66278	2-7/16	86	60	80	1600	1 / 10	17.0	0.43
66280	2-1/2	88	60	80	1680	1 / 10	17.0	0.43
66282	2-9/16	90	60	85	1820	1 / 6	18.0	0.41
66284	2-5/8	92	60	85	1840	1 / 6	12.0	0.41
66286	2-11/16	94	60	85	1840	1 / 6	12.0	0.41
66288	2-3/4	96	60	90	2140	1 / 6	12.0	0.41
66290	2-13/16	98	60	90	2170	1 / 6	14.0	0.41
66292	2-7/8	99	60	90	2230	1 / 6	14.0	0.41
66294	2-15/16	102	60	90	2270	1 / 6	14.5	0.41
66296	3	103.5	60	90	2340	1 / 6	14.5	0.41

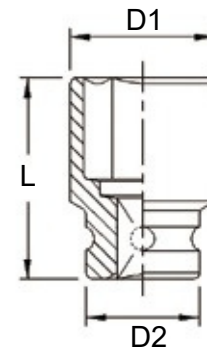
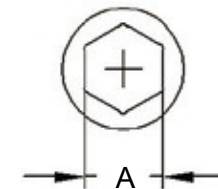

Metric Budd Wheel Sockets

TEM NO.	A	D1	D2	Length	Weight	PCS	G.W.	CUFT
	Square	mm	mm	mm	g	inner/ctn	KGS	
69517S	17mm	34	40	90	520	1 / 30	17.0	0.52
69519S	19mm	38	40	90	570	1 / 30	18.5	0.52
69520S	20mm	40	40	90	600	1 / 30	19.5	0.52
69521S	21mm	40	40	90	610	1 / 30	20.0	0.52



SAE Budd Wheel Sockets

TEM NO.	A	D1	D2	Length	Weight	PCS	G.W.	CUFT
	Square	mm	mm	mm	g	inner/ctn	KGS	
69522S	11/16"	34	40	90	560	1 / 30	17.0	0.52
69524S	3/4"	38	40	90	570	1 / 30	18.5	0.52
69526S	13/16"	40	40	90	580	1 / 30	20.0	0.52

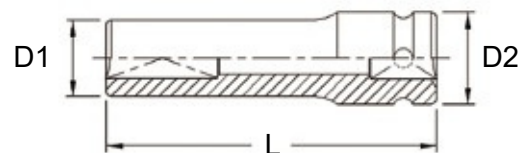
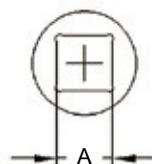

Metric Deep Impact Sockets

Item No.	A mm	D1 mm	D2 mm	Length mm	Weight g	PCS	G.W. KGS	CUFT
						inner/ctn		
649517	17	29.0	38	90	390	1 / 30	13.0	0.52
649518	18	31.0	38	90	400	1 / 30	13.0	0.52
649519	19	32.0	38	90	420	1 / 30	14.0	0.52
649520	20	33.0	38	90	430	1 / 30	14.0	0.52
649521	21	35.0	38	90	450	1 / 30	14.5	0.52
649522	22	36.0	40	90	490	1 / 30	16.0	0.52
649523	23	38.0	40	90	520	1 / 30	16.5	0.52
649524	24	39.0	40	90	530	1 / 30	17.0	0.52
649525	25	40.0	40	90	540	1 / 30	17.5	0.52
649526	26	41.0	41	90	560	1 / 30	18.0	0.52
649527	27	42.0	42	90	580	1 / 30	18.5	0.52
649528	28	44.0	44	90	630	1 / 30	20.0	0.52
649529	29	45.0	44	90	630	1 / 30	20.0	0.52
649530	30	46.0	44	90	680	1 / 30	21.5	0.52
649531	31	46.0	44	90	680	1 / 30	21.5	0.52
649532	32	49.0	44	90	740	1 / 30	23.5	0.52
649533	33	50.0	44	90	760	1 / 30	24.0	0.52
649534	34	51.0	44	90	790	1 / 30	25.0	0.52
649535	35	53.0	44	90	800	1 / 30	25.5	0.52
649536	36	54.0	44	90	840	1 / 30	26.5	0.52
649537	37	55.0	44	90	840	1 / 30	26.5	0.52
649538	38	56.0	44	90	880	1 / 30	28.0	0.52
649539	39	57.0	44	90	880	1 / 10	10.0	0.31
649540	40	59.0	44	90	940	1 / 10	10.5	0.31
649541	41	60.0	44	90	970	1 / 10	11.0	0.31
649542	42	61.0	44	90	990	1 / 10	11.0	0.31
649543	43	62.0	44	90	1000	1 / 10	11.0	0.31
649544	44	64.0	44	90	1170	1 / 10	13.0	0.31
649545	45	65.0	44	95	1180	1 / 10	13.0	0.31
649546	46	66.0	44	95	1180	1 / 10	13.0	0.31
649547	47	67.0	44	95	1190	1 / 10	13.0	0.31
649548	48	69.0	44	100	1250	1 / 10	13.5	0.31
649549	49	70.0	44	100	1350	1 / 10	14.5	0.31
649550	50	71.0	44	100	1400	1 / 10	15.0	0.31
649551	51	72.0	44	100	1400	1 / 10	15.0	0.31
649552	52	73.0	44	100	1580	1 / 6	10.5	0.41
649553	53	74.5	54	100	1600	1 / 6	10.5	0.41
649554	54	76.0	54	100	1660	1 / 6	11.0	0.41
649555	55	78.0	54	100	1720	1 / 6	11.5	0.41
649556	56	79.0	54	100	1720	1 / 6	11.5	0.41
649557	57	80.0	54	100	1730	1 / 6	11.5	0.41
649558	58	81.0	54	100	1740	1 / 6	11.5	0.41
649559	59	83.0	60	100	1750	1 / 6	11.5	0.41
649560	60	84.0	60	105	2070	1 / 6	13.5	0.41
649561	61	85.0	60	105	2070	1 / 6	13.5	0.41
649562	62	85.5	60	105	2070	1 / 6	13.5	0.41
649563	63	88.0	60	105	2150	1 / 6	14.0	0.41
649564	64	89.0	60	105	2200	1 / 6	14.0	0.41
649565	65	90.0	60	105	2240	1 / 6	14.5	0.41
649566	66	91.0	60	105	2240	1 / 6	14.5	0.41
		92.0	60	105	2350	1 / 6	15.0	0.41
649567	67	94.0	60	105	2380	1 / 6	15.5	0.41
649568	68	94.5	60	105	2380	1 / 6	15.5	0.41
649569	69	96.0	60	110	2400	1 / 6	15.5	0.41
649570	70	97.5	60	110	2500	1 / 3	9.0	0.31
649571	71	98.0	60	110	2550	1 / 3	9.0	0.31
649572	72	99.0	60	110	2600	1 / 3	9.0	0.31
649573	73	101.0	60	110	2650	1 / 3	9.0	0.31
649574	74	102.0	60	110	2700	1 / 3	9.0	0.31
649575	75	104.0	60	110	2890	1 / 3	10.0	0.31
649576	76							

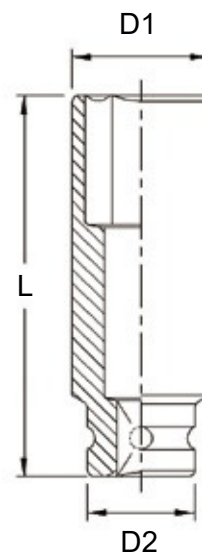
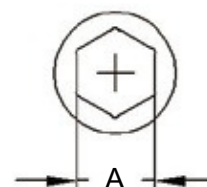



SAE Deep Impact Sockets

Item No.	A inch	D1 mm	D2 mm	Length mm	Weight g	PCS	G.W. KGS	CUFT
						inner/ctn		
9522	11/16	30	38	90	400	1 / 30	13.0	0.52
9524	3/4	32	38	90	420	1 / 30	14.0	0.52
9525	25/32	33	38	90	430	1 / 30	14.0	0.52
9526	13/16	35	38	90	450	1 / 30	14.5	0.52
9528	7/8	36	40	90	490	1 / 30	16.0	0.52
9530	15/16	39	40	90	530	1 / 30	17.0	0.52
9532	1	40	40	90	550	1 / 30	17.5	0.52
9534	1-1/16	42	42	90	580	1 / 30	18.5	0.52
9536	1-1/8	45	44	90	630	1 / 30	20.0	0.52
9538	1-3/16	46	44	90	680	1 / 30	21.5	0.52
9540	1-1/4	49	44	90	740	1 / 30	23.5	0.52
9542	1-5/16	50	44	90	760	1 / 30	24.0	0.52
9544	1-3/8	53	44	90	800	1 / 30	25.5	0.52
9546	1-7/16	54	44	90	840	1 / 30	26.5	0.52
9548	1-1/2	56	44	90	880	1 / 10	10.0	0.31
9550	1-9/16	59	44	90	940	1 / 10	10.5	0.31
9552	1-5/8	60	44	90	970	1 / 10	11.0	0.31
9554	1-11/16	63	44	90	1000	1 / 10	11.0	0.31
9556	1-3/4	65	44	95	1180	1 / 10	13.0	0.31
9558	1-13/16	66	44	95	1180	1 / 10	13.0	0.31
9560	1-7/8	69	44	100	1250	1 / 10	13.5	0.31
9562	1-15/16	70	44	100	1350	1 / 10	14.5	0.31
9564	2	72	44	100	1400	1 / 10	15.0	0.31
9566	2-1/16	73	44	100	1580	1 / 6	10.5	0.41
9568	2-1/8	76	54	100	1660	1 / 6	11.0	0.41
9570	2-3/16	78	54	100	1720	1 / 6	11.5	0.41
9572	2-1/4	80	54	100	1730	1 / 6	11.5	0.41
9574	2-5/16	83	60	100	1750	1 / 6	11.5	0.41
9576	2-3/8	84	60	105	2070	1 / 6	13.5	0.41
9578	2-7/16	86	60	105	2070	1 / 6	13.5	0.41
9580	2-1/2	88	60	105	2150	1 / 6	14.0	0.41
9582	2-9/16	90	60	105	2240	1 / 6	14.5	0.41
9584	2-5/8	92	60	105	2350	1 / 6	15.0	0.41
9586	2-11/16	94	60	105	2380	1 / 6	15.5	0.41
9588	2-3/4	96	60	110	2400	1 / 6	15.5	0.41
9590	2-13/16	97.5	60	110	2500	1 / 3	9.0	0.31
9592	2-7/8	99	60	110	2600	1 / 3	9.0	0.31
9594	2-15/16	102	60	110	2700	1 / 3	9.0	0.31
9596	3	104	60	110	2890	1 / 3	10.0	0.31

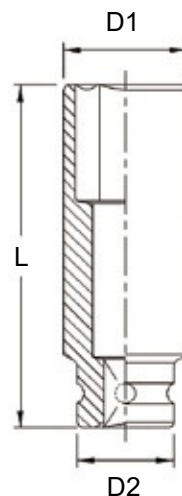
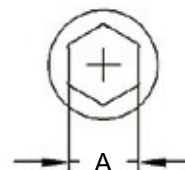

SAE Deep Thin Wall Impact Sockets

Item No.	A inch	D1 mm	D2 mm	Length mm	Weight g	PCS	G.W. KGS	CUFT
						inner/ctn		
669534T	1-1/16	40	42	90	500	1 / 30		0.52
669536T	1-1/8	42	44	90	550	1 / 30	16.5	0.52
669540T	1-1/4	46	44	90	630	1 / 30	17.5 19.5	0.52

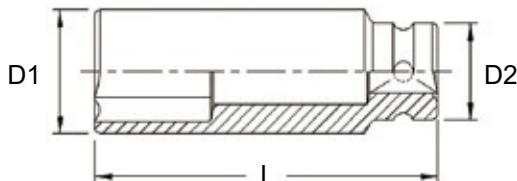
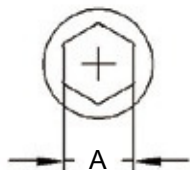

Metric Thin Wall Impact Sockets (12-Point)

Item No.	A mm	D1 mm	D2 mm	Length mm	Weight g	PCS inner/ctn	G.W. KGS	CUFT
65517	17	27.0	38	51	210	5 / 50	11.5	0.34
65518	18	28.0	38	51	220	5 / 50	12.0	0.34
65519	19	29.5	38	51	220	5 / 50	12.0	0.34
65520	20	30.7	38	51	230	5 / 50	12.5	0.34
65521	21	32.0	38	51	230	5 / 50	12.5	0.34
65522	22	33.0	40	51	260	5 / 50	14.0	0.34
65523	23	34.5	40	51	260	5 / 50	14.0	0.34
65524	24	35.7	40	51	270	5 / 50	14.5	0.34
65525	25	37.0	40	51	290	5 / 50	15.5	0.34
65526	26	38.0	40	54	300	5 / 50	16.5	0.34
65527	27	39.5	42	54	310	5 / 50	16.5	0.41
65528	28	42.0	38	54	310	5 / 50	16.5	0.41
65529	29	42.0	39	54	310	5 / 50	16.5	0.41
65530	30	43.0	40	54	330	5 / 50	17.5	0.41
65531	31	44.0	41	54	330	5 / 30	11.0	0.34
65532	32	46.0	42	57	380	5 / 30	12.5	0.34
65533	33	46.0	43	57	380	5 / 30	12.5	0.34
65534	34	48.0	43	57	400	5 / 30	13.0	0.34
65535	35	49.5	44	57	410	5 / 30	13.5	0.34
65536	36	50.7	44	57	420	5 / 30	14.0	0.34
65537	37	51.0	44	57	440	5 / 30	14.5	0.34
65538	38	53.0	44	57	450	5 / 30	14.5	0.34
65539	39	54.5	44	58	480	5 / 30	15.5	0.34
65540	40	55.7	44	58	500	1 / 20	11.0	0.39
65541	41	57.0	44	58	510	1 / 20	11.5	0.39
65542	42	58.0	44	61	520	1 / 20	11.5	0.39
65543	43	59.5	44	61	560	1 / 20	12.5	0.39
65544	44	60.7	44	63	580	1 / 20	13.0	0.39
65545	45	61.0	44	63	600	1 / 20	13.0	0.39
65546	46	63.0	44	63	640	1 / 20	14.0	0.39
65547	47	63.5	44	63	650	1 / 20	14.0	0.39
65548	48	65.7	44	65	680	1 / 20	14.5	0.39
65549	49	67.0	44	65	690	1 / 20	14.5	0.39
65550	50	68.0	44	68	750	1 / 20	16.0	0.39
65551	51	69.0	44	68	770	1 / 20	16.5	0.39
65552	52	70.7	54	70	930	1 / 20	19.5	0.39
65553	53	72.0	54	70	1000	1 / 10	11.0	0.43
65554	54	73.0	54	73	1040	1 / 10	11.5	0.43
65555	55	74.5	54	73	1050	1 / 10	11.5	0.43
65556	56	75.7	54	73	1070	1 / 10	12.0	0.43
65557	57	77.0	54	73	1100	1 / 10	12.0	0.43
65558	58	78.0	54	73	1170	1 / 10	13.0	0.43
65559	59	79.0	60	73	1240	1 / 10	13.5	0.43
65560	60	80.7	60	80	1350	1 / 10	14.5	0.43
65563	63	84.0	60	80	1430	1 / 10	15.5	0.43
65565	65	87.0	60	85	1560	1 / 6	10.5	0.41
65570	70	93.0	60	90	1790	1 / 6	12.0	0.41

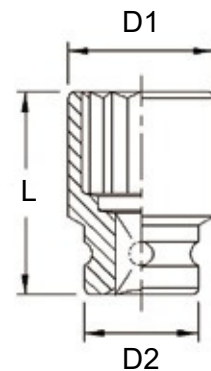
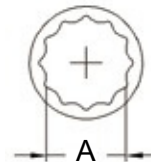

Impact Adapters

Item No.	Female Drive	Male Drive	Length mm	Weight g	PCS inner/ctn	G.W. KGS	CUFT
64060	3/4"	1/2" w/Pin Hole	63	260	5 / 50	14.0	0.34
64060B	3/4"	1/2" w/Steel Ball	63	260	5 / 50	14.0	0.34
64068	3/4"	1" w/Pin Hole	65	370	1 / 30	14.0	0.38
64068B	3/4"	1" w/Steel Ball	65	370	1 / 30	13.0	0.38



SAE Thin Wall Impact Sockets (12-Point)

Item No.	A inch	D1 mm	D2 mm	Length mm	Weight g	PCS	G.W	CUFT
						inner/ctn		
5222	11/16	27.6	38	51	210	5 / 50		0.34
5224	3/4	29.6	38	51	220	5 / 50	11.5	0.34
5225	25/32	30.5	38	51	230	5 / 50	12.0	0.34
5226	13/16	31.5	38	51	230	5 / 50	12.5	0.34
5228	7/8	33.0	40	51	260	5 / 50	12.5	0.34
5230	15/16	35.5	40	51	270	5 / 50	14.0	0.34
5232	1	37.5	40	54	300	5 / 50	14.5	0.34
5234	1-1/16	39.5	42	54	310	5 / 50	16.0	0.41
5236	1-1/8	42.0	42	54	310	5 / 50	16.5	0.41
5238	1-3/16	43.0	43	54	330	5 / 50	16.5	0.41
5240	1-1/4	46.0	44	57	380	5 / 30	17.5	0.34
5242	1-5/16	46.0	44	57	380	5 / 30	12.5	0.34
5244	1-3/8	50.0	44	57	410	5 / 30	12.5	0.34
5246	1-7/16	51.0	44	57	440	5 / 30	13.5	0.34
5248	1-1/2	53.0	44	57	450	5 / 30	14.5	0.34
5250	1-9/16	55.4	44	58	500	1 / 20	14.5	0.39
5252	1-5/8	57.0	44	58	510	1 / 20	11.0	0.39
5254	1-11/16	59.3	44	61	560	1 / 20	11.5	0.39
5256	1-3/4	61.0	44	63	600	1 / 20	12.5	0.39
5258	1-13/16	63.0	44	63	640	1 / 20	13.0	0.39
5260	1-7/8	65.3	44	65	680	1 / 20	14.0	0.39
5262	1-15/16	67.0	44	65	690	1 / 20	14.5	0.39
5264	2	69.0	44	68	770	1 / 20	14.5	0.39
5266	2-1/16	71.0	54	70	930	1 / 20	16.5	0.39
5268	2-1/8	73.0	54	73	1040	1 / 10	19.5	0.43
5270	2-3/16	75.0	54	73	1050	1 / 10	11.5	0.43
5272	2-1/4	77.0	54	73	1100	1 / 10	11.5	0.43
5274	2-5/16	79.0	60	73	1240	1 / 10	12.0	0.43
5276	2-3/8	81.0	60	80	1350	1 / 10	13.5	0.43
5280	2-1/2	84.0	60	80	1430	1 / 10	14.5	0.43
5284	2-5/8	89.0	60	85	1500	1 / 6	15.5	0.41
5288	2-3/4	93.0	60	90	1790	1 / 6	10.0	0.41

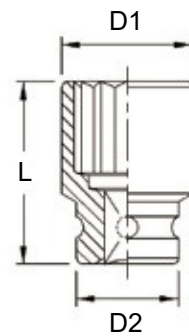

Impact Universal Joints

Item No.	Type	Outside Diameter	Length mm	Weight g	PCS inner/ctn	G.W. KGS	CUFT
640606	w/Pin Hole	44mm	110	680	1 / 12	9.0	0.30
640606B	w/Steel Ball	44mm	110	680	1 / 12	9.0	0.30



Impact Extension Bars

Item No.	Length mm	Weight g	PCS inner/ctn	G.W	CUFT
640100	100 w/Pin Hole	455	1 / 30		0.52
640100B	100 w/Steel Ball	455	1 / 30	15.0	0.52
640150	150 w/Pin Hole	645	1 / 20	15.0	0.52
640150B	150 w/Steel Ball	645	1 / 20	14.0	0.52
640200	200 w/Pin Hole	825	1 / 20	14.0	0.62
640200B	200 w/Steel Ball	825	1 / 20	17.5	0.62
640250	250 w/Pin Hole	1030	2 / 20	17.5	0.62
640250B	250 w/Steel Ball	1030	2 / 20	22.0	0.62
640400	400 w/Pin Hole	1600	1 / 15	22.0	0.43
640400B	400 w/Steel Ball	1600	1 / 15	25.0	0.43



Impact Socket Sets

3/4

CM-021M 8 Piece 3/4" Dr. Metric Impact Socket Set

Item No.	Size	Item No.	Size
3/4" Dr. 6pt Impact Socket:			
26mm	32mm		
27mm	35mm		
29mm	36mm		
30mm	38mm		



6 pt.

4150 g 6 sets / 26 Kgs / 0.62 CUFT

AM-608M 8 Piece 3/4" Dr. SAE Impact Socket Set

Item No.	Size	Item No.	Size
3/4" Dr. 6pt Impact Socket:			
1" 1-1/16"	1-5/16"		
1-1/8"	1-3/8"		
1-1/4"	1-7/16"		
1-1/2"	1-1/2"		



6 pt.

4150 g 6 sets / 26 Kgs / 0.62 CUFT

AS-609E 9 Piece 3/4" Dr. Metric Impact Socket Set

Item No.	Size	Item No.	Size
3/4" Dr. 6pt Impact Socket:			
19mm	32mm		
22mm	33mm		
24mm	34mm		
27mm	36mm		
30mm			



6 pt.

4000 g 4 sets / 17 Kgs / 0.85 CUFT

DK-621M 21 Piece 3/4" Dr. Metric Deep Impact Socket Set

Item No.	Size	ItemNo.	Size
3/4" Dr. 6pt Deep Impact Socket:			
19mm	36mm		
21mm	38mm		
22mm	40mm		
23mm	41mm		
24mm	42mm		
27mm	43mm		
29mm	45mm		
30mm	46mm		
32mm	48mm		
33mm	50mm		
35mm			



6 pt.

19 Kg 1 set / 20 Kgs / 0.91 CUFT

DC-608M4 8 Piece 3/4" Dr. Metric Budd Wheel Impact Socket Set

Item No.	Size	ItemNo.	Size
3/4" Dr. 6pt Deep Impact Socket:			
27mm	35mm		
30mm	38mm		
32mm	41mm		
3/4" Dr. Budd Wheel Impact Socket:			
Metal Box	19mm	21mm	



6 pt.

□

6500 g 4 sets / 27 Kgs / 0.62 CUFT

Metric Impact Sockets

Item No.	A mm	D1 mm	D2 mm	Length mm	Weight g	PCS inner/ctn	G.W	CUFT
84717	17	33.0	50	60	470	1 / 30		0.38
84718	18	34.3	50	60	480	1 / 30	15.0	0.38
84719	19	35.6	50	60	500	1 / 30	15.5	0.38
84720	20	36.9	50	60	500	1 / 30	16.0	0.38
84721	21	38.1	50	60	510	1 / 30	16.0	0.38
84722	22	39.4	50	60	520	1 / 30	16.5	0.38
84723	23	40.6	50	60	520	1 / 30	16.5	0.38
84724	24	41.9	50	60	530	1 / 30	16.5	0.38
84725	25	43.2	50	60	530	1 / 30	17.0	0.38
84726	26	44.4	50	60	540	1 / 30	17.0	0.38
84727	27	45.7	50	60	550	1 / 30	17.0	0.38
84728	28	46.9	50	60	560	1 / 30	17.5	0.38
84729	29	48.2	50	60	560	1 / 30	18.0	0.38
84730	30	49.0	50	62	580	1 / 30	18.0	0.38
84731	31	50.0	50	62	580	1 / 30	18.5	0.38
84732	32	52.0	52	63	650	1 / 30	18.5	0.38
84733	33	53.0	53	63	670	1 / 30	20.5	0.38
84734	34	54.0	54	63	700	1 / 30	21.0	0.38
84735	35	55.6	52	63	700	1 / 30	22.0	0.38
84736	36	56.9	53	67	750	1 / 20	22.0	0.39
84737	37	58.2	54	67	750	1 / 20	16.0	0.39
84738	38	59.4	54	67	800	1 / 20	16.0	0.39
84739	39	60.7	54	67	840	1 / 20	17.0	0.39
84740	40	61.9	54	67	850	1 / 20	18.0	0.39
84741	41	63.1	54	70	900	1 / 20	18.0	0.39
84742	42	64.3	54	70	920	1 / 20	19.0	0.39
84743	43	65.6	54	70	920	1 / 20	19.5	0.39
84744	44	66.8	54	70	920	1 / 20	19.5	0.39
84745	45	68.0	54	70	1000	1 / 20	19.5	0.39
84746	46	69.4	54	70	1020	1 / 20	21.0	0.39
84747	47	70.7	54	70	1050	1 / 10	21.5	0.43
84748	48	71.9	54	70	1050	1 / 10	11.5	0.43
84749	49	73.2	54	70	1050	1 / 10	11.5	0.43
84750	50	74.4	54	70	1080	1 / 10	11.5	0.43
84751	51	75.2	54	70	1080	1 / 10	12.0	0.43
84752	52	76.9	54	82	1300	1 / 10	12.0	0.43
84753	53	78.2	54	82	1350	1 / 10	14.0	0.43
84754	54	79.4	54	82	1400	1 / 10	14.5	0.43
84755	55	80.7	55	87	1580	1 / 10	15.0	0.43
84756	56	82.0	55	87	1580	1 / 10	17.0	0.43
84757	57	83.2	57	87	1650	1 / 10	17.0	0.43
84758	58	84.4	57	87	1700	1 / 10	17.5	0.43
84759	59	85.7	57	87	1780	1 / 10	18.0	0.43
84760	60	86.9	60	91	1960	1 / 6	19.0	0.41
84761	61	88.1	60	91	1960	1 / 6	13.0	0.41
84762	62	88.9	60	91	1970	1 / 6	13.0	0.41
84763	63	90.7	60	91	2000	1 / 6	13.0	0.41
84764	64	92.0	60	91	2000	1 / 6	13.0	0.41
84765	65	93.2	65	95	2300	1 / 6	13.0	0.41
84766	66	94.4	65	95	2330	1 / 6	15.0	0.41
		95.7	65	95	2330	1 / 6	15.0	0.41
84767	67	96.9	65	95	2350	1 / 6	15.0	0.41
84768	68	98.1	65	95	2350	1 / 6	15.0	0.41
84769	69	99.4	70	100	2730	1 / 6	15.0	0.41
84770	70						17.5	

6 pt.

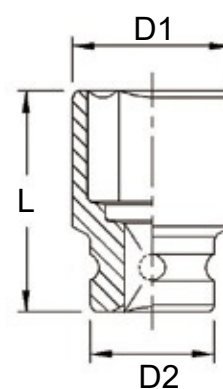
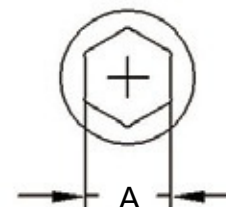

• Sizenore than71mm onthenext page.

Metric Impact Sockets

Item No.	A mm	D1 mm	D2 mm	Length mm	Weight g	PCS inner/ctn	G.W	CUFT
84771	71	100.6	70	100	2730	1 / 6		0.41
84772	72	101.4	70	100	2730	1 / 6	17.5	0.41
84773	73	103.1	70	100	2800	1 / 6	17.5	0.41
84774	74	104.3	70	100	2980	1 / 6	18.0	0.41
84775	75	105.6	70	105	3150	1 / 6	19.0	0.41
84776	76	107.0	70	105	3200	1 / 3	20.0	0.31
84777	77	108.4	70	105	3300	1 / 3	10.5	0.31
84778	78	109.0	70	105	3300	1 / 3	11.0	0.31
84779	79	111.2	70	105	3600	1 / 3	11.0	0.31
84780	80	111.9	80	105	3700	1 / 3	12.0	0.31
84782	82	113.3	80	105	3700	1 / 3	12.0	0.31
84783	83	114.0	80	105	3800	1 / 3	12.0	0.31
84785	85	119.0	86	110	4200	1 / 3	12.5	0.31
84790	90	124.0	86	110	4700	1 / 3	13.5	0.31
84795	95	132.0	86	120	5500	1 / 3	15.0	0.31
84100	100	138.0	86	120	6100	1 / 2	17.5	0.31
84105	105	143.0	95	120	6600	1 / 2	13.0	0.31
84110	110	148.0	95	120	6800	1 / 2	14.0	0.31
84115	115	155.0	95	120	7200	1 / 2	14.5	0.31



Metric Deep Impact Sockets

Item No.	A mm	D1 mm	D2 mm	Length mm	Weight g	PCS inner/ctn	KGS	CUFT
89541	41	63.1	54	90	1180	1 / 10	13.0	0.31
89542	42	64.3	54	90	1200	1 / 10	13.0	0.31
89543	43	65.6	54	90	1240	1 / 10	13.5	0.31
89544	44	66.8	54	90	1240	1 / 10	13.5	0.31
89545	45	68.0	54	90	1400	1 / 10	15.0	0.31
89546	46	69.4	54	100	1500	1 / 10	16.0	0.31
89547	47	70.7	54	100	1500	1 / 10	16.0	0.31
89548	48	71.9	54	100	1530	1 / 10	16.5	0.31
89549	49	73.2	54	100	1530	1 / 10	16.5	0.31
89550	50	74.4	54	100	1680	1 / 10	18.0	0.31
89551	51	75.2	54	100	1680	1 / 6	11.0	0.41
89552	52	76.4	54	100	1700	1 / 6	11.0	0.41
89553	53	78.2	54	100	1700	1 / 6	11.0	0.41
89554	54	79.4	54	100	1750	1 / 6	12.0	0.41
89555	55	80.7	55	110	2000	1 / 6	13.0	0.31
89556	56	82.0	55	110	2000	1 / 6	13.0	0.31
89557	57	82.7	57	110	2140	1 / 6	14.0	0.31
89558	58	84.0	57	110	2140	1 / 6	14.0	0.31
89559	59	85.7	57	110	2140	1 / 6	14.0	0.31
89560	60	86.9	60	110	2420	1 / 6	15.5	0.31
89561	61	88.1	60	110	2420	1 / 6	15.5	0.31
89562	62	88.9	60	110	2460	1 / 6	16.0	0.31
89563	63	90.7	60	120	2700	1 / 6	17.0	0.41
89564	64	92.0	60	120	2700	1 / 6	17.0	0.41
89565	65	93.2	65	120	2900	1 / 6	18.5	0.41
89566	66	94.4	65	120	2900	1 / 6	18.5	0.41
89567	67	95.7	65	120	3000	1 / 6	19.0	0.41
89568	68	96.9	65	120	3060	1 / 6	19.5	0.41
89569	69	98.1	65	120	3100	1 / 6	19.5	0.41
89570	70	100.0	70	125	3500	1 / 6	22.0	0.41
89571	71	101.0	70	125	3500	1 / 3	11.5	0.31
89572	72	102.0	70	125	3700	1 / 3	12.0	0.31
89573	73	103.0	70	125	3880	1 / 3	12.5	0.31
89574	74	104.0	70	125	3950	1 / 3	13.0	0.31
89575	75	106.0	70	150	4850	1 / 3	15.5	0.31
89576	76	107.0	70	150	4850	1 / 3	15.5	0.31
89577	77	108.0	70	150	4850	1 / 3	15.5	0.31
89578	78	110.0	70	150	5200	1 / 3	16.5	0.31
89579	79	111.0	70	150	5200	1 / 3	16.5	0.31
89580	80	112.0	80	150	5400	1 / 2	12.0	0.30
89582	82	113.0	80	150	5400	1 / 2	12.0	0.30
89583	83	114.0	80	150	5600	1 / 2	12.0	0.30
89585	85	118.0	86	160	6600	1 / 2	14.0	0.30
89590	90	124.0	86	160	7000	1 / 2	15.0	0.30
89595	95	132.0	86	160	8000	1 / 2	17.0	0.31
89600	100	138.0	86	160	8500	1 / 2	18.0	0.31
89605	105	143.0	95	160	9100	1 / 2	19.0	0.39
89610	110	148.0	95	160	9450	1 / 2	20.0	0.39
89615	115	155.0	95	160	10300	1 / 2	21.5	0.39

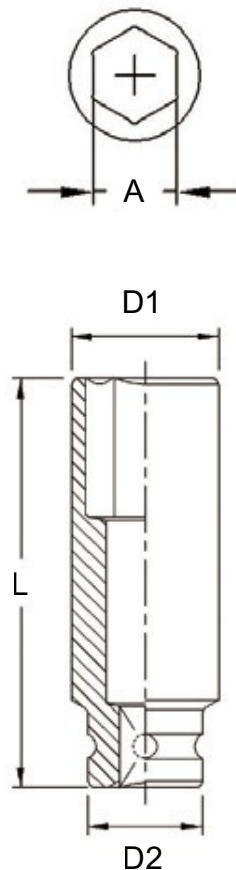



Impact Sockets

SAE Impact Sockets

Item No.	A inch	D1 mm	D2 mm	Length mm	Weight g	PCS	G.W	CUFT
						inner/ctn		
86024	3/4	35.6	50	60	500	1 / 30		0.38
86025	25/32	36.9	50	60	500	1 / 30	16.0	0.38
86026	13/16	37.7	50	60	510	1 / 30	16.0	0.38
86028	7/8	39.4	50	60	520	1 / 30	16.5	0.38
86030	15/16	41.9	50	60	530	1 / 30	16.5	0.38
86032	1	43.6	50	60	530	1 / 30	17.0	0.38
86034	1-1/16	45.7	50	60	550	1 / 30	17.0	0.38
86036	1-1/8	47.7	50	60	560	1 / 30	17.5	0.38
86038	1-3/16	49.4	50	62	580	1 / 30	18.0	0.38
86040	1-1/4	52.0	52	63	650	1 / 30	18.5	0.38
86042	1-5/16	53.0	53	63	670	1 / 30	20.5	0.38
86044	1-3/8	55.6	52	63	700	1 / 30	21.0	0.38
86046	1-7/16	57.4	54	67	750	1 / 20	22.0	0.39
86048	1-1/2	59.4	54	67	800	1 / 20	16.0	0.39
86050	1-9/16	61.9	54	67	850	1 / 20	17.0	0.39
86052	1-5/8	63.1	54	70	900	1 / 20	18.0	0.39
86054	1-11/16	65.6	54	70	920	1 / 20	19.0	0.39
86056	1-3/4	67.8	54	70	1000	1 / 20	19.5	0.39
86058	1-13/16	69.4	54	70	1020	1 / 20	21.0	0.39
86060	1-7/8	71.9	54	70	1050	1 / 10	21.5	0.43
86062	1-15/16	73.1	54	70	1050	1 / 10	11.5	0.43
86064	2	75.2	54	70	1080	1 / 10	11.5	0.43
86066	2-1/16	76.9	54	82	1300	1 / 10	12.0	0.43
86068	2-1/8	79.4	54	82	1400	1 / 10	14.0	0.43
86070	2-3/16	80.7	55	87	1580	1 / 10	15.0	0.43
86072	2-1/4	83.2	57	87	1650	1 / 10	17.0	0.43
86074	2-5/16	85.7	57	87	1780	1 / 10	17.5	0.43
86076	2-3/8	86.9	60	91	1960	1 / 6	19.0	0.41
86078	2-7/16	88.9	60	91	1970	1 / 6	13.0	0.41
86080	2-1/2	90.7	60	91	2000	1 / 6	13.0	0.41
86082	2-9/16	93.2	65	95	2300	1 / 6	13.0	0.41
86084	2-5/8	95.2	65	95	2330	1 / 6	15.0	0.41
86086	2-11/16	96.9	65	95	2350	1 / 6	15.0	0.41
86088	2-3/4	99.4	70	100	2730	1 / 6	15.0	0.41
86090	2-13/16	100.6	70	100	2730	1 / 6	17.5	0.41
86092	2-7/8	103.1	70	100	2800	1 / 6	17.5	0.41
86094	2-15/16	105.6	70	105	3150	1 / 6	18.0	0.41
86096	3	107.0	70	105	3200	1 / 3	20.0	0.31
86098	3-1/16	109.0	70	105	3300	1 / 3	10.5	0.31
86100	3-1/8	111.9	80	105	3600	1 / 3	11.0	0.31
86102	3-3/16	113.3	80	105	3800	1 / 3	12.0	0.31
86104	3-1/4	114.0	80	105	3800	1 / 3	12.5	0.31
86106	3-5/16	116.0	80	105	3900	1 / 3	12.5	0.31
86108	3-3/8	119.0	86	110	4300	1 / 3	13.0	0.31
86110	3-7/16	120.0	86	110	4400	1 / 3	14.0	0.31
86112	3-1/2	121.0	86	110	4500	1 / 3	14.0	0.31
86114	3-9/16	124.0	86	110	4700	1 / 3	14.5	0.31
86116	3-5/8	126.0	86	110	4900	1 / 3	15.0	0.31
86118	3-11/16	129.0	86	110	5200	1 / 3	16.0	0.31
86120	3-3/4	132.0	86	120	5500	1 / 3	16.5	0.31
86122	3-13/16	134.0	86	120	5800	1 / 3	17.5	0.31
86124	3-7/8	135.0	86	120	5900	1 / 3	18.5	0.31
86126	3-15/16	138.0	86	120	6100	1 / 2	19.0	0.31
86128	4	139.0	86	120	6100	1 / 2	13.0	0.31
86130	4-1/16	142.0	86	120	6300	1 / 2	13.0	0.31
86132	4-1/8	143.0	95	120	6600	1 / 2	13.5	0.31
86134	4-3/16	145.0	95	120	6700	1 / 2	14.0	0.31
86136	4-1/4	147.0	95	120	6800	1 / 2	14.5	0.31
86138	4-5/16	148.0	95	120	6800	1 / 2	14.5	0.31
86140	4-3/8	149.0	95	120	6900	1 / 2	14.5	0.31
86142	4-7/16	152.0	95	120	7000	1 / 2	15.0	0.31
86144	4-1/2	155.0	95	120	7200	1 / 2	15.0	0.31

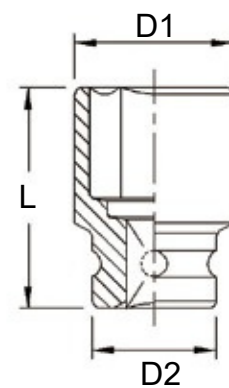
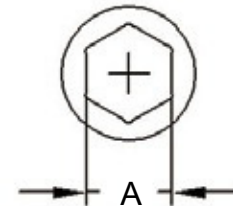

SAE Deep Impact Sockets

Item No.	A inch	D1 mm	D2 mm	Length mm	Weight g	PCS inner/ctn	G.W	CUFT
169524	3/4	35.6	50	90	620	1 / 20		0.34
169525	25/32	36.9	50	90	630	1 / 20	13.5	0.34
169526	13/16	37.7	50	90	670	1 / 20	13.5	0.34
169528	7/8	39.4	50	90	700	1 / 20	14.5	0.34
169530	15/16	41.9	50	90	740	1 / 20	15.0	0.34
169532	1	43.6	50	90	750	1 / 20	16.0	0.34
169534	1-1/16	45.7	50	90	800	1 / 20	16.0	0.34
169536	1-1/8	47.7	50	90	840	1 / 20	17.0	0.34
169538	1-3/16	49.4	50	90	840	1 / 20	18.0	0.34
169540	1-1/4	52.0	52	90	900	1 / 20	18.0	0.34
169542	1-5/16	53.0	53	90	950	1 / 10	19.0	0.31
169544	1-3/8	55.6	52	90	1000	1 / 10	10.5	0.31
169546	1-7/16	57.4	54	90	1050	1 / 10	11.0	0.31
169548	1-1/2	59.4	54	90	1100	1 / 10	11.5	0.31
169550	1-9/16	61.4	54	90	1100	1 / 10	12.0	0.31
169552	1-5/8	63.1	54	90	1180	1 / 10	12.0	0.31
169554	1-11/16	65.1	54	90	1240	1 / 10	13.0	0.31
169556	1-3/4	67.8	54	90	1400	1 / 10	13.5	0.31
169558	1-13/16	69.4	54	100	1500	1 / 10	15.0	0.31
169560	1-7/8	71.4	54	100	1530	1 / 10	16.0	0.31
169562	1-15/16	73.1	54	100	1530	1 / 6	16.5	0.41
169564	2	75.2	54	100	1680	1 / 6	10.0	0.41
169566	2-1/16	76.9	54	100	1700	1 / 6	11.0	0.41
169568	2-1/8	79.4	54	100	1750	1 / 6	11.0	0.41
169570	2-3/16	80.7	55	110	2000	1 / 6	12.0	0.41
169572	2-1/4	82.7	57	110	2140	1 / 6	13.0	0.41
169574	2-5/16	85.7	57	110	2140	1 / 6	14.0	0.31
169576	2-3/8	86.9	60	110	2420	1 / 6	14.0	0.31
169578	2-7/16	88.9	60	110	2460	1 / 6	15.5	0.31
169580	2-1/2	90.7	60	120	2700	1 / 6	16.0	0.41
169582	2-9/16	93.2	65	120	2900	1 / 6	17.0	0.41
169584	2-5/8	95.2	65	120	3000	1 / 6	18.5	0.41
169586	2-11/16	96.9	65	120	3060	1 / 6	19.0	0.41
169588	2-3/4	99.4	70	125	3500	1 / 6	19.5	0.41
169590	2-13/16	101.0	70	125	3500	1 / 3	22.0	0.31
169592	2-7/8	103.0	70	125	3880	1 / 3	11.5	0.31
169594	2-15/16	106.0	70	150	4850	1 / 3	12.5	0.31
169596	3	107.0	70	150	4850	1 / 3	15.5	0.31
169598	3-1/16	110.0	70	150	5200	1 / 3	15.5	0.31
169600	3-1/8	112.0	70	150	5200	1 / 2	16.5	0.31
169602	3-3/16	113.0	80	150	5400	1 / 2	11.5	0.31
169604	3-1/4	114.0	80	150	5400	1 / 2	12.0	0.31
169606	3-5/16	116.0	80	150	5600	1 / 2	12.0	0.31
169608	3-3/8	118.0	86	160	6500	1 / 2	12.0	0.31
169610	3-7/16	120.0	86	160	6500	1 / 2	14.0	0.31
169612	3-1/2	122.0	86	160	6700	1 / 2	14.0	0.31
169614	3-9/16	124.0	86	160	7000	1 / 2	14.5	0.31
169616	3-5/8	128.0	86	160	7500	1 / 2	15.0	0.31
169618	3-11/16	130.0	86	160	7700	1 / 2	16.0	0.31
169620	3-3/4	132.0	86	160	8000	1 / 2	16.5	0.31
		134.0	86	160	8100	1 / 2	17.0	0.31
169622	3-13/16	136.0	86	160	8300	1 / 2	17.0	0.31
169624	3-7/8	138.0	86	160	8500	1 / 2	17.5	0.31
169626	3-15/16	139.0	86	160	8600	1 / 2	18.0	0.31
169628	4	142.0	86	160	8800	1 / 2	18.0	0.31
169630	4-1/16	143.0	95	160	9100	1 / 2	18.5	0.39
169632	4-1/8	145.0	95	160	9300	1 / 2	19.0	0.39
169634	4-3/16	147.0	95	160	9450	1 / 2	19.5	0.39
169636	4-1/4	148.0	95	160	9450	1 / 2	20.0	0.39
169638	4-5/16	149.0	95	160	9800	1 / 2	20.0	0.39
169640	4-3/8	152.0	95	160	10000	1 / 2	20.5	0.39
169642	4-7/16	155.0	95	160	10300	1 / 2	21.0	0.39
169644	4-1/2						21.5	

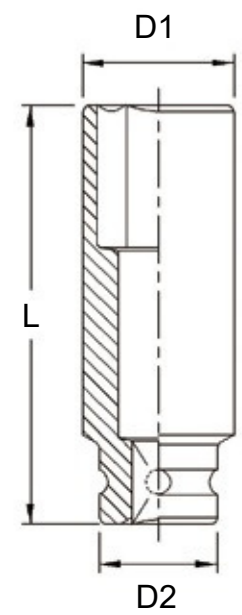
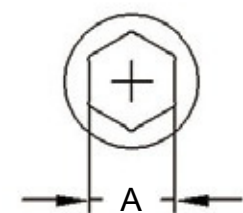



Impact Sockets

Impact Adapters

Item No.	Female Drive	Male Drive	Length mm	Weight g	PCS inner/ctn	G.W .	CUFT
841006	1"	3/4" w/Pin Hole	75	580	1 / 30		0.52
841006B	1"	3/4" w/Steel Ball	75	580	1 / 30	18.5	0.52
841012	1"	1-1/2" w/Pin Hole	80	920	1 / 30	18.5	0.52
841012B	1"	1-1/2" w/Steel Ball	80	920	1 / 30	28.5 28.5	0.52



Impact Universal Joints

Item No.	Type	Outside Diameter mm	Length mm	Weight g	PCS inner/ctn	G.W .	CUFT
840808	w/Pin Hole	52mm	130	1100	1 / 20		0.52
840808B	w/Steel Ball	52mm	130	1100	1 / 20	23.5 23.5	0.52



Impact Extension Bars

Item No. (Previous No.)	Length mm	Weight g	PCS inner/ctn	G.W .	CUFT
840150	150 w/Pin Hole	1230	2 / 12		0.34
840150B	150 w/Steel Ball	1230	2 / 12	16.0	0.34
840200	200 w/Pin Hole	1560	2 / 12	16.0	0.34
840200B	200 w/Steel Ball	1560	2 / 12	20.0	0.34
840250	250 w/Pin Hole	1900	2 / 6	20.0	0.34
840250B	250 w/Steel Ball	1900	2 / 6	12.5	0.34
840400	400 w/Pin Hole	2920	1 / 6	12.5	0.41
840400B	400 w/Steel Ball	2920	1 / 6	18.5 18.5	0.41



MM-809M 9 Piece 1" Dr. Metric Impact Socket Set

Item No.	Size	Item No.	Size
1" Dr. 6pt Impact Socket:			
24mm	38mm		
27mm	41mm		
30mm	46mm		
32mm	50mm		
35mm			



6 pt.

MM-817S 17 Piece 1" Dr. SAE Impact Socket Set

Item No.	Size	Item No.	Size
1" Dr. 6pt Impact Socket:			
1-7/16"	2-3/16"		
1-1/2" 1-	2-1/4" 2-		
5/8" 1-	3/8" 2-		
11/16"	1/2" 2-		
1-3/4" 1-	5/8" 2-		
13/16"	3/4" 2-		
1-7/8"	15/16"		
2" 2-	3-1/8"		
1/8"			



6 pt.

Jumbo Impact Sockets

1 1/2

Metric Jumbo Impact Sockets

Item No.	A mm	D1 mm	D2 mm	Length mm	Weight g
38432	32	56	86	80	1950
38433	33	57	86	80	1950
38434	34	59	86	80	1950
38435	35	62	86	80	2000
38436	36	63	86	80	2000
38437	37	64	86	80	2000
38438	38	65	86	80	2050
38439	39	65	86	80	2050
38440	40	67	86	80	2050
38441	41	68	86	80	2100
38442	42	69	86	80	2100
38443	43	70	86	80	2100
38446	46	74	86	84	2200
38450	50	79	86	84	2300
38452	52	82	86	84	2300
38454	54	84	86	84	2350
38455	55	86	86	90	2500
38458	58	89	86	90	2600
38460	60	92	86	90	2700
38463	63	96	86	95	3000
38465	65	98	86	95	3050
38470	70	104	86	100	3400
38475	75	110	86	105	3800
38477	77	113	86	105	4100
38478	78	114	86	105	4150
38480	80	116	86	110	4300
38485	85	123	86	110	4600
38490	90	129	86	112	5050
38495	95	136	127	112	7350
38500	100	142	127	115	7800
38505	105	148	127	120	8500
38510	110	154	127	124	9250
38515	115	160	127	128	9900
38520	120	167	127	132	10900
38525	125	174	127	136	11850
38530	130	180	127	140	12700
38535	135	186	127	145	13750
38540	140	192	127	150	14900
38545	145	198	127	155	16000
38550	150	204	127	160	17300
38555	155	210	127	165	18600
38560	160	218	127	170	20600
38565	165	224	127	175	22000



6 pt.

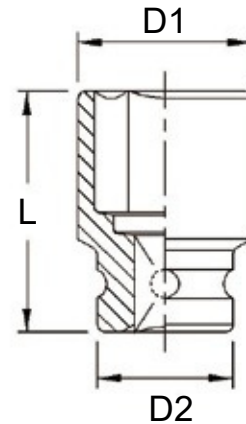
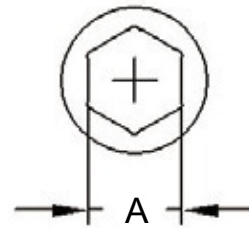

Impact Adapters

1" / Pin Hole 1" / Steel Ball 2-1/2"

Item No.	Female Drive	Length mm	Weight g	PCS	G.W	CUFT
93808	1-1/2"	98	2500	6		0.41
93808B	1-1/2"	98	2500	6	16.0	0.41
93820	1-1/2"	125	4000	6	16.0 25.0	0.41

Impact Universal Joint (Quick Release)

Item No.	Outside Diameter	Length mm	Weight g	PCS	G.W	CUFT
94099	86mm	175	4400	5	23.0	0.30



SAE Jumbo Impact Sockets

Item No.	A inch	D1 mm	D2 mm	Length mm	Weight g	Item No.	A inch	D1 mm	D2 mm	Length mm	Weight g
8640	1-1/4	56	86	80	1950	8724	3-7/8	140	127	115	7750
8642	1-5/16	57	86	80	1950	8726	3-15/16	142	127	115	7800
8644	1-3/8	62	86	80	2000	8728	4	144	127	120	8250
8646	1-7/16	64	86	80	2000	8730	4-1/16	146	127	120	8450
8648	1-1/2	65	86	80	2050	8732	4-1/8	148	127	120	8500
8650	1-9/16	67	86	80	2050	8734	4-3/16	150	127	120	8700
8652	1-5/8	68	86	80	2100	8736	4-1/4	152	127	124	9150
8654	1-11/16	70	86	80	2100	8738	4-5/16	154	127	124	9250
8656	1-3/4	72	86	80	2150	8740	4-3/8	156	127	124	9450
8658	1-13/16	74	86	84	2200	8742	4-7/16	158	127	124	9550
8660	1-7/8	76	86	84	2250	8744	4-1/2	160	127	128	9900
8662	1-15/16	78	86	84	2250	8746	4-9/16	162	127	128	10100
8664	2	80	86	84	2300	8748	4-5/8	164	127	132	10600
8666	2-1/16	82	86	84	2300	8750	4-11/16	166	127	132	10850
8668	2-1/8	84	86	84	2350	8752	4-3/4	167	127	132	10900
8670	2-3/16	86	86	90	2500	8754	4-13/16	170	127	132	11150
8672	2-1/4	88	86	90	2600	8756	4-7/8	172	127	136	11600
8674	2-5/16	90	86	90	2650	8758	4-15/16	174	127	136	11850
8676	2-3/8	92	86	90	2700	8760	5	176	127	140	12300
8678	2-7/16	94	86	95	2900	8762	5-1/16	178	127	140	12600
8680	2-1/2	96	86	95	3000	8764	5-1/8	180	127	140	12700
8682	2-9/16	98	86	95	3050	8766	5-3/16	182	127	140	12850
8684	2-5/8	100	86	100	3250	8768	5-1/4	184	127	145	13600
8686	2-11/16	102	86	100	3350	8770	5-5/16	186	127	145	13750
8688	2-3/4	104	86	100	3400	8772	5-3/8	188	127	145	14000
8690	2-13/16	106	86	105	3700	8774	5-7/16	190	127	150	14750
8692	2-7/8	108	86	105	3750	8776	5-1/2	192	127	150	14900
8694	2-15/16	110	86	105	3800	8778	5-9/16	194	127	150	15050
8696	3	112	86	105	4000	8780	5-5/8	196	127	155	15850
8698	3-1/16	114	86	105	4050	8782	5-11/16	198	127	155	16000
8700	3-1/8	116	86	110	4300	8784	5-3/4	200	127	155	16300
8702	3-3/16	118	86	110	4400	8786	5-13/16	202	127	160	17100
8704	3-1/4	120	86	110	4500	8788	5-7/8	204	127	160	17300
8706	3-5/16	122	86	110	4600	8790	5-15/16	206	127	160	17650
8708	3-3/8	124	86	110	4650	8792	6	208	127	160	17900
8710	3-7/16	126	86	112	4900	8794	6-1/16	210	127	165	18600
8712	3-1/2	128	86	112	5000	8796	6-1/8	212	127	165	18950
8714	3-9/16	129	86	112	5050	8798	6-3/16	214	127	165	19350
8716	3-5/8	132	86	112	5200	8800	6-1/4	216	127	170	20200
8718	3-11/16	134	86	112	5250	8802	6-5/16	218	127	170	20600
8720	3-3/4	136	127	112	7350	8804	6-3/8	220	127	170	20800
8722	3-13/16	138	127	115	7550	8806	6-7/16	222	127	170	21000
						8808	6-1/2	224	127	175	22000

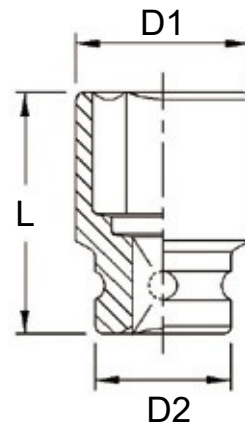
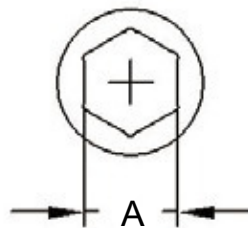

Deep Jumbo Impact Sockets

1 1/2

6 pt.

Metric Deep Jumbo Impact Sockets

Item No.	A mm	D1 mm	D2 mm	Length mm	Weight g
39435	35	62	86	120	2800
39436	36	63	86	120	2800
39437	37	64	86	120	2800
39438	38	65	86	120	2850
39439	39	66	86	120	2850
39440	40	67	86	120	2850
39441	41	68	86	120	2850
39442	42	69	86	120	2900
39443	43	70	86	120	2900
39446	46	74	86	130	3200
39450	50	79	86	140	3600
39452	52	82	86	140	3750
39454	54	84	86	140	3800
39455	55	86	86	150	4200
39458	58	89	86	150	4350
39460	60	92	86	150	4600
39463	63	96	86	150	4850
39465	65	98	86	150	4950
39470	70	104	86	150	5350
39475	75	110	86	160	6200
39480	80	116	86	170	7050
39485	85	123	86	170	7700
39490	90	129	86	180	8750
39495	95	136	127	180	11550
39500	100	142	127	190	12800
39505	105	148	127	190	13700
39510	110	154	127	200	14900
39515	115	160	127	200	15800
39520	120	167	127	210	17900
39525	125	174	127	210	19000
39530	130	180	127	210	19950
39535	135	186	127	220	22100
39540	140	192	127	220	23150
39545	145	198	127	220	24200
39550	150	204	127	230	26600
39555	155	210	127	230	28000
39560	160	218	127	230	29800
39565	165	224	127	230	31000

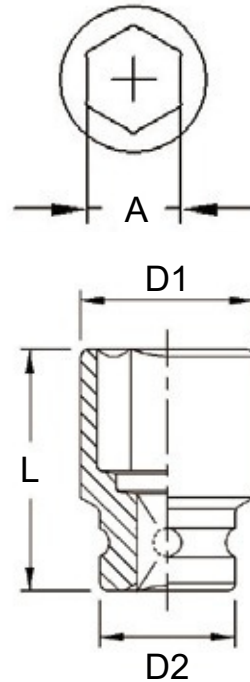

Sliding T-Handle

Item No.	Length mm	Weight g	PCS	G.W	CUFT
98090T	915	8500	2	18.0	0.45



Impact Extension Bars

Item No.	Length mm	Weight g	PCS	G.W	CUFT
8175	175	4000	5		0.44
8250	250	4800	4	21.0	0.30
8330	330	6150	2	20.0	0.31
				13.5	



SAE Deep Jumbo Impact Sockets

Item No.	A inch	D1 mm	D2 mm	Length mm	Weight g
1-38		62	86	120	2800
1-7/16		64	86	120	2800
1-1/2		65	86	120	2850
1-9/16		67	86	120	2850
1-5/8		68	86	120	2850
1-11/16		70	86	120	2900
1-3/4		72	86	120	2950
1-13/16		74	86	130	3200
1-7/8		76	86	130	3250
1-15/16		78	86	130	3350
2		80	86	140	3650
2-1/16		82	86	140	3750
2-1/8		84	86	140	3800
2-3/16		86	86	150	4200
2-1/4		88	86	150	4300
2-5/16		90	86	150	4400
2-3/8		92	86	150	4600
2-7/16		94	86	150	4700
2-1/2		96	86	150	4850
2-9/16		98	86	150	4950
2-5/8		100	86	150	5050
2-11/16		102	86	150	5250
2-3/4		104	86	150	5350
2-13/16		106	86	160	5900
2-7/8		108	86	160	6050
2-15/16		110	86	160	6200
3		112	86	170	6850
3-1/16		114	86	170	7000
3-1/8		116	86	170	7050
3-3/16		118	86	170	7300
3-1/4		120	86	170	7400
3-5/16		122	86	170	7650
3-3/8		124	86	170	7800
3-7/16		126	86	170	8050
3-1/2		128	86	170	8200
3-9/16		129	86	180	8750
3-5/8		132	86	180	9100
3-11/16		134	86	180	9300
3-3/4		136	127	180	11550
3-13/16		138	127	180	11700
3-7/8		140	127	180	12000
3-15/16		142	127	190	12800

Item No.	A inch	D1 mm	D2 mm	Length mm	Weight g
4		144	127	190	13100
4-1/16		146	127	190	13450
4-1/8		148	127	190	13700
4-3/16		150	127	190	13850
4-1/4		152	127	190	14050
4-5/16		154	127	200	14900
4-3/8		156	127	200	15300
4-7/16		158	127	200	15600
4-1/2		160	127	200	15800
4-9/16		162	127	200	16150
4-5/8		164	127	200	16550
4-11/16		166	127	200	17050
4-3/4		167	127	210	17900
4-13/16		170	127	210	18350
4-7/8		172	127	210	18500
4-15/16		174	127	210	19000
5		176	127	210	19300
5-1/16		178	127	210	19750
5-1/8		180	127	210	19950
5-3/16		182	127	210	20350
5-1/4		184	127	210	20700
5-5/16		186	127	220	22100
5-3/8		188	127	220	22700
5-7/16		190	127	220	22900
5-1/2		192	127	220	23150
5-9/16		194	127	220	23550
5-5/8		196	127	220	23800
5-11/16		198	127	220	24200
5-3/4		200	127	220	24700
5-13/16		202	127	220	24950
5-7/8		204	127	230	26600
5-15/16		206	127	230	27250
6		208	127	230	27800
6-1/16		210	127	230	28000
6-1/8		212	127	230	28500
6-3/16		214	127	230	29200
6-1/4		216	127	230	29500
6-5/16		218	127	230	29800
6-3/8		220	127	230	30300
6-7/16		222	127	230	30800
6-1/2		224	127	230	31000

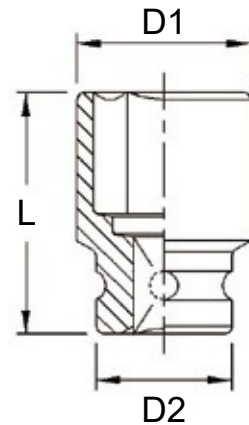
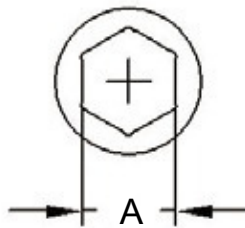

Jumbo Impact Sockets

2 1/2

6 pt.

Metric Jumbo Impact Sockets

Item No.	A mm	D1 mm	D2 mm	Length mm	Weight g
60	98	127	127	125	6800
63	102	127	127	125	6850
65	104	127	127	125	6850
70	110	127	127	125	6900
75	116	127	127	125	7000
80	123	127	127	125	7200
85	129	127	135	135	7900
90	135	127	135	135	8200
95	142	127	140	140	8950
100	148	127	145	145	9700
105	154	127	150	150	10450
110	160	127	155	155	11300
115	166	127	160	160	12200
120	173	127	160	160	12900
125	179	175	165	165	19000
130	185	175	170	170	20000
135	192	175	175	175	21400
140	198	175	180	180	22800
145	204	175	185	185	24200
150	210	175	190	190	25600
155	216	175	195	195	27000
160	223	175	200	200	29100
165	229	175	205	205	30800
170	235	175	210	210	32400
175	242	175	210	210	33800
180	248	175	215	215	35600
185	254	175	220	220	38000
190	260	175	220	220	39000
195	266	175	225	225	41100
200	273	175	225	225	42600
205	279	175	230	230	44900
210	285	175	235	235	47300
215	292	175	240	240	50400
220	298	175	245	245	53000
225	304	175	250	250	55800
230	310	175	255	255	58600
235	316	175	260	260	61700

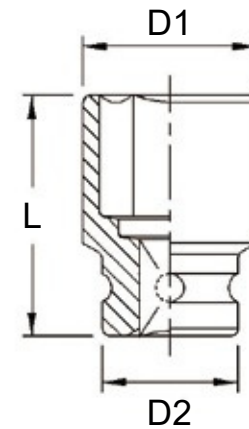
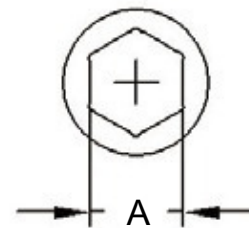

Impact Adapter

Item No.	Female Drive	Male Drive	Length mm	Weight g	PCS	G.W	CUFT
	2-1/2"	1-1/2"	135	7500	2	16.0	0.30



Impact Extension Bars

Item No.	Male Drive	Length mm	Weight g	PCS	G.W	CUFT
	2-1/2"	250	10000	1	11.0	0.30
	2-1/2"	320	15500	1	16.5	0.31



SAE Jumbo Impact Sockets

Item No.	A inch	D1 mm	D2 mm	Length mm	Weight g
2-3/8	98	127	127	125	6800
2-7/16	100	127	127	125	6800
2-1/2	102	127	127	125	6850
2-9/16	104	127	127	125	6850
2-5/8	106	127	127	125	6900
2-11/16	108	127	127	125	6900
2-3/4	110	127	127	125	6900
2-13/16	112	127	127	125	7000
2-7/8	114	127	127	125	7000
2-15/16	116	127	127	125	7000
3	118	127	127	125	7100
3-1/16	120	127	127	125	7100
3-1/8	123	127	127	125	7200
3-3/16	124	127	127	125	7200
3-1/4	126	127	127	125	7200
3-5/16	128	127	135	135	7850
3-3/8	130	127	135	135	7950
3-7/16	132	127	135	135	8100
3-1/2	134	127	135	135	8150
3-9/16	135	127	135	135	8200
3-5/8	138	127	135	135	8400
3-11/16	140	127	135	135	8500
3-3/4	142	127	140	140	8950
3-13/16	144	127	140	140	9050
3-7/8	145	127	140	140	9100
3-15/16	148	127	145	145	9700
4	150	127	145	145	9800
4-1/16	152	127	150	150	10350
4-1/8	154	127	150	150	10450
4-3/16	155	127	150	150	10500
4-1/4	158	127	155	155	11200
4-5/16	160	127	155	155	11300
4-3/8	162	127	155	155	11500
4-7/16	164	127	155	155	11650
4-1/2	166	127	160	160	12200
4-9/16	168	127	160	160	12450
4-5/8	170	127	160	160	12600
4-11/16	172	127	160	160	12800
4-3/4	173	127	160	160	12900
4-13/16	175	127	160	160	13000
4-7/8	178	175	165	165	18900
4-15/16	179	175	165	165	19000
5	182	175	165	165	19350
5-1/16	183	175	165	165	19400
5-1/8	185	175	170	170	20000
5-3/16	188	175	170	170	20400
5-1/4	189	175	170	170	20500
5-5/16	192	175	175	175	21400
5-3/8	193	175	175	175	21500
5-7/16	195	175	175	175	21700
5-1/2	198	175	180	180	22800
5-9/16	200	175	180	180	23000
5-5/8	202	175	180	180	23300
5-11/16	204	175	185	185	24200
5-3/4	205	175	185	185	24300
5-13/16	208	175	185	185	24700
5-7/8	210	175	190	190	25600
5-15/16	212	175	190	190	26000

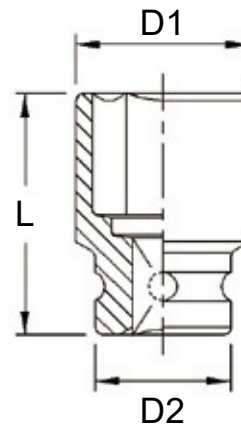
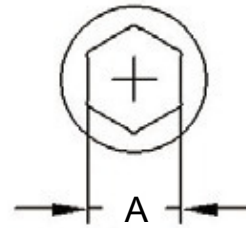

• Size more than 6" on the next page.

****Please Note****

Any sockets with drivesize of 2-1/2" or higher are not stock items and will have to be custom ordered. Please allow for lead times of up to 60 days

SAE Jumbo Impact Sockets

Item No.	A inch	D1 mm	D2 mm	Length mm	Weight g
6		213	175	190	26100
6-1/16		216	175	195	27000
6-1/8		218	175	195	27200
6-3/16		219	175	195	27700
6-1/4		222	175	195	28200
6-5/16		223	175	200	29100
6-3/8		225	175	200	29400
6-7/16		228	175	200	29900
6-1/2		229	175	205	30800
6-9/16		232	175	205	31400
6-5/8		233	175	205	31500
6-11/16		235	175	210	32400
6-3/4		238	175	210	33000
6-13/16		239	175	210	33100
6-7/8		242	175	210	33800
6-15/16		243	175	210	33900
7		245	175	210	34100
7-1/16		248	175	215	35600
7-1/8		249	175	215	35800
7-3/16		252	175	215	36400
7-1/4		253	175	215	36600
7-5/16		254	175	220	38000
7-3/8		256	175	220	38200
7-7/16		259	175	220	38900
7-1/2		260	175	220	39000
7-9/16		263	175	220	39700
7-5/8		265	175	220	39900
7-11/16		266	175	225	41100
7-3/4		269	175	225	41800
7-13/16		272	175	225	42500
7-7/8		273	175	225	42600
7-15/16		275	175	225	42900
8		276	175	225	43000
8-1/16		279	175	230	44900
8-1/8		280	175	230	45000
8-3/16		283	175	230	45800
8-1/4		285	175	235	47300
8-5/16		286	175	235	47600
8-3/8		289	175	235	48200
8-7/16		292	175	240	50400
8-1/2		293	175	240	50600
8-9/16		295	175	240	50800
8-5/8		298	175	245	53000
8-11/16		299	175	245	53200
8-3/4		300	175	245	53400
8-13/16		303	175	245	54100
8-7/8		304	175	250	55800
8-15/16		306	175	250	56200
9		309	175	250	57000
9-1/16		310	175	255	58600
		313	175	255	59600
920992	9-1/8	314	175	255	59700
920994	9-3/16	316	175	260	61700
920996	9-1/4				

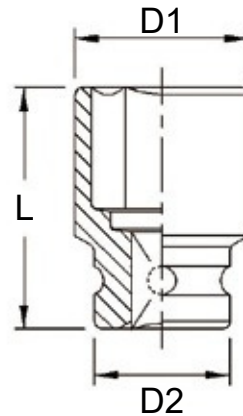
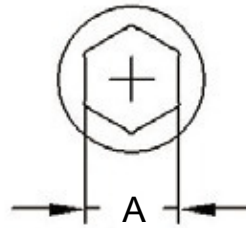



Jumbo Impact Sockets

Metric Jumbo Impact Sockets

Item No.	A mm	D1 mm	D2 mm	Length mm	Weight g
105	160	175	175	175	18400
110	166	175	175	175	18650
115	172	175	175	180	19400
120	180	175	175	185	20800
125	186	175	175	190	21900
130	192	175	175	195	23100
135	198	175	175	200	24300
140	204	175	175	205	25650
145	210	200	210	210	31500
150	216	200	210	210	32600
155	222	200	215	215	34200
160	230	200	220	220	36700
165	236	200	225	225	38700
170	242	200	225	225	39750
175	248	200	230	230	41800
180	254	200	230	230	42900
185	260	200	235	235	45100
190	268	200	240	240	48450
195	274	200	240	240	49500
200	280	200	245	245	52000
205	286	200	250	250	54500
210	292	200	255	255	57000
215	298	200	260	260	59800
220	304	200	265	265	62500
225	312	200	265	265	65000
230	318	200	270	270	68000
235	324	200	275	275	70800

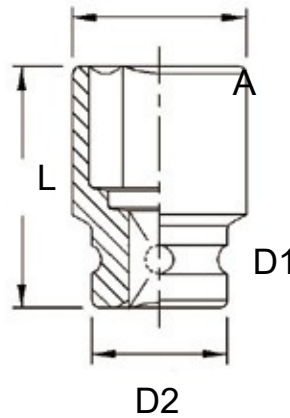
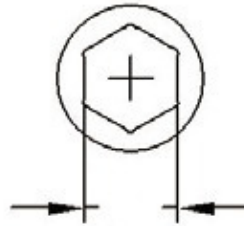

SAE Jumbo Impact Sockets

Item No.	A inch	D1 mm	D2 mm	Length mm	Weight g
4-1/8	160	175	175	175	18400
4-3/16	162	175	175	175	18600
4-1/4	164	175	175	175	18600
4-5/16	166	175	175	175	18650
4-3/8	168	175	175	175	18850
4-7/16	170	175	175	175	18900
4-1/2	172	175	180	180	19400
4-9/16	174	175	180	180	19600
4-5/8	176	175	180	180	19700
4-11/16	178	175	180	180	20000
4-3/4	180	175	185	185	20800
4-13/16	182	175	185	185	20900
4-7/8	184	175	185	185	21000
4-15/16	186	175	190	190	21900
5	188	175	190	190	22000
5-1/16	190	175	190	190	22300
5-1/8	192	175	195	195	23100
5-3/16	194	175	195	195	23200
5-1/4	196	175	195	195	23500
5-5/16	198	175	200	200	24300
5-3/8	200	175	200	200	24600
5-7/16	202	175	200	200	24850
5-1/2	204	175	205	205	25650
5-9/16	206	175	205	205	25900
5-5/8	208	175	205	205	26300
5-11/16	210	200	210	210	31500
5-3/4	212	200	210	210	32100
5-13/16	214	200	210	210	32300
5-7/8	216	200	210	210	32600
5-15/16	218	200	210	210	33000
6	220	200	210	210	33400
6-1/16	222	200	215	215	34200
6-1/8	224	200	215	215	34650
6-3/16	226	200	215	215	35100
6-1/4	228	200	215	215	35400
6-5/16	230	200	220	220	36700
6-3/8	232	200	220	220	37000
6-7/16	234	200	220	220	37350
6-1/2	236	200	225	225	38700
6-9/16	238	200	225	225	39000
6-5/8	240	200	225	225	39500
6-11/16	242	200	225	225	39750
6-3/4	244	200	225	225	40000
6-13/16	246	200	225	225	40500
6-7/8	248	200	230	230	41800
6-15/16	250	200	230	230	42400

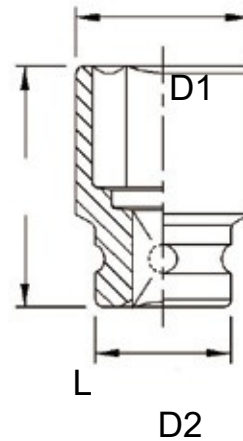
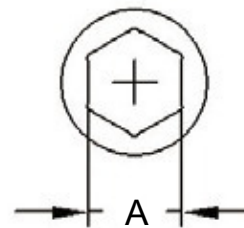

• Sizemorethan7"on thenext page.



Jumbo Impact Sockets

SAE JumboImpact Sockets

Item No.	A inch	D1 mm	D2 mm	Length mm	Weight g
928424	7	252	200	230	42600
928426	7-1/16	254	200	230	42900
928428	7-1/8	256	200	230	43450
928430	7-3/16	258	200	230	43700
928432	7-1/4	260	200	235	45100
928434	7-5/16	262	200	235	45700
928436	7-3/8	264	200	235	46200
928438	7-7/16	266	200	235	46500
928440	7-1/2	268	200	240	48450
928442	7-9/16	270	200	240	48700
928444	7-5/8	272	200	240	49000
928446	7-11/16	274	200	240	49500
928448	7-3/4	276	200	240	49800
928450	7-13/16	278	200	240	50400
928452	7-7/8	280	200	245	52000
928454	7-15/16	282	200	245	52300
928456	8	284	200	245	52850
928458	8-1/16	286	200	250	54500
928460	8-1/8	288	200	250	55200
928462	8-3/16	290	200	250	55450
928464	8-1/4	292	200	255	57000
928466	8-5/16	294	200	255	57700
928468	8-3/8	296	200	255	58000
928470	8-7/16	298	200	260	59800
928472	8-1/2	300	200	260	60500
928474	8-9/16	302	200	260	60800
928476	8-5/8	304	200	265	62500
928478	8-11/16	306	200	265	63300
928480	8-3/4	308	200	265	64000
928482	8-13/16	310	200	265	64300
928484	8-7/8	312	200	265	65000
928486	8-15/16	314	200	265	65300
928488	9	316	200	265	65700
928490	9-1/16	318	200	270	68000
928492	9-1/8	320	200	270	68400
928494	9-3/16	322	200	270	69200
928496	9-1/4	324	200	275	70800

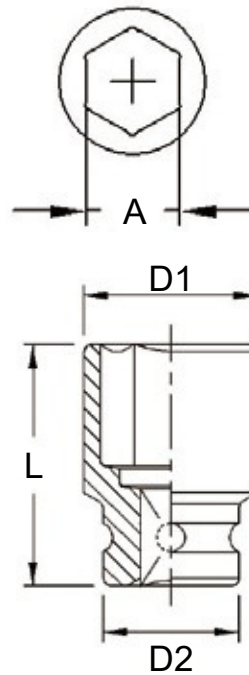

#5 Spline Drive Impact Sockets

#5 Spline Dr. Metric Impact Sockets

Item No.	A mm	D1 mm	D2 mm	Length mm	Weight g	PCS	G.W	CUFT
22	38	60	70	680	24	17.0	0.44	
24	40	60	70	700	24	18.0	0.44	
25	42	60	70	720	24	18.5	0.44	
27	44	60	70	730	24	19.0	0.44	
29	46	60	70	750	24	20.5	0.44	
30	48	60	70	760	24	21.0	0.44	
32	50	60	75	810	24	22.0	0.44	
33	52	60	75	840	24	23.5	0.44	
35	54	60	77	870	24	24.0	0.44	
38	58	60	81	950	10	11.0	0.31	
41	62	60	81	1030	10	11.5	0.31	
46	68	60	86	1200	6	13.0	0.41	

6 pt.



#5 Spline Dr. SAE Impact Sockets

Item No.	A inch	D1 mm	D2 mm	Length mm	Weight g	PCS	G.W. KGS	CUFT
7/8	38	60	70	680	24	17.0	0.44	
15/16	40	60	70	700	24	18.0	0.44	
1	42	60	70	720	24	18.5	0.44	
1-1/16	44	60	70	730	24	19.0	0.44	
1-1/8	46	60	70	750	24	19.5	0.44	
1-3/16	48	60	70	760	24	20.0	0.44	
1-1/4	50	60	75	810	24	20.5	0.44	
1-5/16	52	60	75	820	24	21.0	0.44	
1-3/8	54	60	77	840	24	22.0	0.44	
1-7/16	56	60	77	870	24	22.5	0.44	
1-1/2	58	60	81	920	24	23.5	0.44	
1-9/16	60	60	81	950	24	24.0	0.44	
1-5/8	62	60	81	1030	10	11.0	0.31	
1-11/16	64	60	81	1050	10	11.5	0.31	
1-3/4	66	60	86	1150	10	12.5	0.31	
1-13/16	68	60	86	1200	10	13.5	0.31	
1-7/8	70	60	89	1260	10	14.0	0.31	
1-15/16	72	60	89	1340	6	9.0	0.41	
2	74	60	89	1400	6	9.5	0.41	
2-1/8	78	60	94	1600	6	11.0	0.41	
2-3/16	80	60	95	1700	6	11.5	0.41	
2-1/4	82	60	98	1830	6	12.0	0.41	
2-3/8	86	60	100	2000	6	13.5	0.41	
2-1/2	90	60	100	2050	6	14.0	0.41	
2-5/8	94	60	105	2380	6	15.5	0.41	
2-3/4	98	60	105	2420	6	16.0	0.41	
3	106	60	105	3030	6	19.5	0.41	

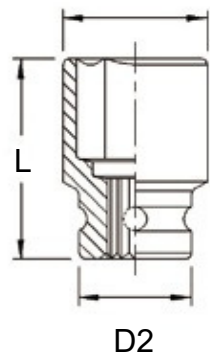
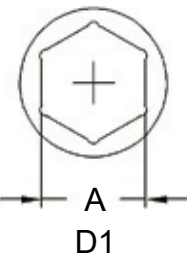

#5 Spline Dr. Metric & SAE Budd Wheel Sockets

ITEM NO.	A Square	D1 mm	D2 mm	Length mm	Weight g	PCS	G.W	CUFT
17mm	40	60	70	750	24	19.0	0.44	
19mm	42	60	70	750	24	19.0	0.44	
20mm	43	60	70	760	24	19.0	0.44	
21mm	44	60	70	760	24	19.0	0.44	
3/4"	42	60	70	750	24	19.0	0.44	
13/16"	44	60	70	850	24	19.5	0.44	
15/16"	48	60	70	890	24	20.0	0.44	

6 pt.





#5 Spline Dr. SAE Deep Budd Wheel Sockets

ITEM NO.	A Hex	D1 mm	D2 mm	Length mm	Weight g	PCS	G.W	CUFT
1-1/2"	58	60	115	1330	10	14.5	0.30	

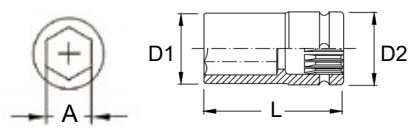
6 pt.





#5 Spline Dr. Metric Deep Impact Sockets

Item No.	A mm	D1 mm	D2 mm	Length mm	Weight g	PCS 	G.W.	CUFT 
22	38	60	60	80	820	20		0.52
24	40	60	60	80	850	20	19.5	0.52
25	42	60	60	80	890	20	20.0	0.52
27	44	60	60	80	920	20	20.5	0.52
29	46	60	60	80	960	20	21.0	0.52
30	48	60	60	80	990	20	21.0	0.52
32	50	60	60	80	1030	20	22.0	0.52
33	52	60	60	80	1110	10	22.5	0.31
35	54	60	60	90	1150	10	12.0	0.31
38	58	60	60	90	1190	10	12.5	0.31
41	62	60	60	90	1270	10	13.0	0.31
46	68	60	60	100	1400	10	14.0	0.31
							15.0	



#5 Spline Dr. SAE Deep Impact Sockets

Item No.	A inch	D1 mm	D2 mm	Length mm	Weight g	PCS 	G.W.	CUFT 
7/8	38	60	60	80	820	20		0.52
15/16	40	60	60	80	850	20	19.5	0.52
1	42	60	60	80	890	20	20.0	0.52
1-1/16	44	60	60	80	920	20	20.5	0.52
1-1/8	46	60	60	80	960	20	21.0	0.52
1-3/16	48	60	60	80	990	20	21.0	0.52
1-1/4	50	60	60	80	1030	20	22.0	0.52
1-5/16	52	60	60	80	1060	10	22.5	0.31
1-3/8	54	60	60	90	1100	10	11.5	0.31
1-7/16	56	60	60	90	1140	10	12.0	0.31
1-1/2	58	60	60	90	1180	10	12.5	0.31
1-9/16	60	60	60	90	1200	10	13.0	0.31
1-5/8	62	60	60	90	1230	10	13.0	0.31
1-11/16	64	60	60	90	1250	10	13.5	0.31
1-3/4	66	60	60	100	1280	10	14.0	0.31
1-13/16	68	60	60	100	1400	10	14.5	0.31
1-7/8	70	60	60	100	1500	10	15.0	0.31
1-15/16	72	60	60	100	1600	6	16.0	0.31
2	74	60	60	100	1700	6	11.5	0.31
2-1/8	78	60	60	100	1800	6	12.5	0.31
2-3/16	80	60	60	100	2100	6	13.0	0.31
2-1/4	82	60	60	120	2200	6	13.5	0.31
2-3/8	86	60	60	120	2400	6	15.0	0.31
2-1/2	90	60	60	120	2600	6	16.0	0.31
2-5/8	94	60	60	120	3050	6	18.0	0.31
2-3/4	98	60	60	135	3400	3	19.0	0.31
3	106	60	60	135	4450	3	10.5	0.31
							15.0	

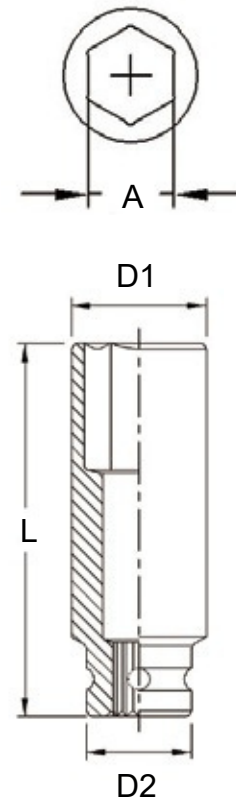

#5 Spline Dr. Deep Thin Wall Impact Sockets

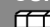
ITEM NO.	A Hex	D1 mm	D2 mm	Length mm	Weight g	PCS 	G.W. KGS	CUFT 
1-1/16"	40	60	60	80	850	10	10.0	0.31
1-1/8"	42	60	60	80	910	10	10.5	0.31
1-1/4"	46	60	60	80	950	10	10.5	0.31

